



## Tool Holder Bushings

CNC Bushings – Black Oxide Finish – Types C, CV, B, DD, J & Z (continued)

### Type DD (continued)

D Outside Diameter (Inch)	d Inside Diameter (Inch)	L Length Under Head (Inch)	A (Inch)	B (Inch)	F (Inch)	Code	D Outside Diameter (Inch)	d Inside Diameter (Inch)	L Length Under Head (Inch)	A (Inch)	B (Inch)	F (Inch)	Code
1-1/2	7/8	2-1/2	11/16	1-1/8	7/8	310783	2-1/2	7/8	4	7/8	1-3/4	1-1/4	310802
1-1/2	1	2-1/2	11/16	1-1/8	7/8	310784	2-1/2	1	4	7/8	1-3/4	1-1/4	310803
1-1/2	1-1/4	2-1/2	11/16	1-1/8	7/8	310785	2-1/2	1-1/4	4	7/8	1-3/4	1-1/4	310804
<b>7 Piece Set – 3/8" to 1-1/4"</b>						<b>300859</b>	2-1/2	1-1/2	4	7/8	1-3/4	1-1/4	310805
1-3/4	1/2	3	3/4	1-1/4	7/8	310786	2-1/2	1-3/4	4	7/8	1-3/4	1-1/4	310806
1-3/4	5/8	3	3/4	1-1/4	7/8	310787	2-1/2	2	4	7/8	1-3/4	1-1/4	310807
1-3/4	3/4	3	3/4	1-1/4	7/8	310788	2-1/2	2-1/4	4	7/8	1-3/4	1-1/4	300862
1-3/4	7/8	3	3/4	1-1/4	7/8	310789	<b>8 Piece Set – 3/4" to 2-1/4"</b>						<b>300863</b>
1-3/4	1	3	3/4	1-1/4	7/8	310790	3	1	4-1/2	1	2	1-1/4	300864
1-3/4	1-1/4	3	3/4	1-1/4	7/8	310791	3	1-1/4	4-1/2	1	2	1-1/4	300865
1-3/4	1-1/2	3	3/4	1-1/4	7/8	310792	3	1-1/2	4-1/2	1	2	1-1/4	300866
<b>7 Piece Set – 1/2" to 1-1/2"</b>						<b>300860</b>	3	1-3/4	4-1/2	1	2	1-1/4	300867
2	1/2	3-1/2	3/4	1-1/2	1	310793	3	2	4-1/2	1	2	1-1/4	300868
2	5/8	3-1/2	3/4	1-1/2	1	310794	3	2-1/4	4-1/2	1	2	1-1/4	300869
2	3/4	3-1/2	3/4	1-1/2	1	310795	<b>6 Piece Set – 1" to 2-1/4"</b>						<b>300870</b>
2	7/8	3-1/2	3/4	1-1/2	1	310796	3-1/2	1-1/2	5-1/4	1-1/4	2-1/2	1-1/4	300871
2	1	3-1/2	3/4	1-1/2	1	310797	3-1/2	1-3/4	5-1/4	1-1/4	2-1/2	1-1/4	300872
2	1-1/4	3-1/2	3/4	1-1/2	1	310798	3-1/2	2	5-1/4	1-1/4	2-1/2	1-1/4	300873
2	1-1/2	3-1/2	3/4	1-1/2	1	310799	3-1/2	2-1/4	5-1/4	1-1/4	2-1/2	1-1/4	300874
2	1-3/4	3-1/2	3/4	1-1/2	1	310800	3-1/2	2-1/2	5-1/4	1-1/4	2-1/2	1-1/4	300875
<b>8 Piece Set – 1/2" to 1-3/4"</b>						<b>300861</b>	3-1/2	3	5-1/4	1-1/4	2-1/2	1-1/4	300876
2-1/2	3/4	4	7/8	1-3/4	1-1/4	310801	<b>6 Piece Set – 1-1/2" to 3"</b>						<b>300877</b>

### Type J

- J bushings have a long solid body with two holes for clamping directly on the tool with set screws for positive alignment of the cutting edge of the tool

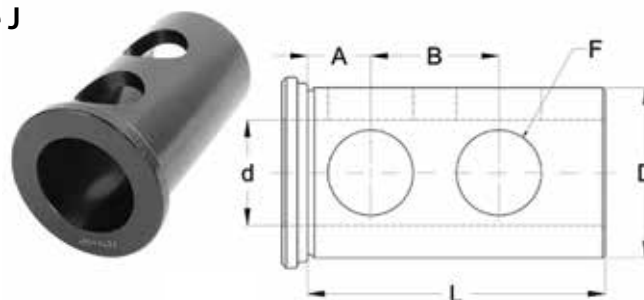

D Outside Diameter (Inch)	d Inside Diameter (Inch)	L Length Under Head (Inch)	A (Inch)	B (Inch)	F Hole Diameter (Inch)	Code	D Outside Diameter (Inch)	d Inside Diameter (Inch)	L Length Under Head (Inch)	A (Inch)	B (Inch)	F Hole Diameter (Inch)	Code
1	1/2	1-3/4	7/16	7/8	5/8	310418	1-1/2	3/4	2-1/2	11/16	1-1/8	7/8	310455
1	5/8	1-3/4	7/16	7/8	5/8	310420	1-1/2	7/8	2-1/2	11/16	1-1/8	7/8	310766
1	3/4	1-3/4	7/16	7/8	5/8	310422	1-1/2	1	2-1/2	11/16	1-1/8	7/8	310459
<b>3 Piece Set – 1/2" to 3/4"</b>						<b>300878</b>	1-1/2	1-1/4	2-1/2	11/16	1-1/8	7/8	310463
1-1/4	3/8	2-1/8	5/8	1	3/4	310436	<b>7 Piece Set – 3/8" to 1-1/4"</b>						<b>300880</b>
1-1/4	1/2	2-1/8	5/8	1	3/4	310437	1-3/4	1/2	3	3/4	1-1/4	7/8	310470
1-1/4	5/8	2-1/8	5/8	1	3/4	310440	1-3/4	5/8	3	3/4	1-1/4	7/8	310472
1-1/4	3/4	2-1/8	5/8	1	3/4	310441	1-3/4	3/4	3	3/4	1-1/4	7/8	310474
1-1/4	7/8	2-1/8	5/8	1	3/4	310764	1-3/4	7/8	3	3/4	1-1/4	7/8	310767
1-1/4	1	2-1/8	5/8	1	3/4	310445	1-3/4	1	3	3/4	1-1/4	7/8	310478
<b>6 Piece Set – 3/8" to 1"</b>						<b>300879</b>	1-3/4	1-1/4	3	3/4	1-1/4	7/8	310482
1-1/2	3/8	2-1/2	11/16	1-1/8	7/8	310765	1-3/4	1-1/2	3	3/4	1-1/4	7/8	310486
1-1/2	1/2	2-1/2	11/16	1-1/8	7/8	310451	<b>7 Piece Set – 1/2" to 1-1/2"</b>						<b>300881</b>
1-1/2	5/8	2-1/2	11/16	1-1/8	7/8	310453	2	1/2	3-1/2	3/4	1-1/2	1	310490