

Expanding Mandrels



Model	Range (mm)	Range (Inch)	Length (mm)	Length (Inch)	Diameter (mm)	Diameter (Inch)	l (mm)	l (Inch)	Complete	Sleeve Only
									Code	Code
LM-1	13 – 19	0.51 – 0.75	165	6.5	11	0.43	40	1.57	165101	165201
LM-2	19 – 25	0.75 – 1.00	196	7.7	13	0.50	60	2.36	165102	165202
LM-3	25 – 33	1.00 – 1.30	257	10.0	17	0.67	90	3.54	165103	165203
LM-4	33 – 42	1.30 – 1.66	297	11.7	23	0.91	120	4.72	165104	165204
LM-5	42 – 52	1.66 – 2.05	338	13.3	30	1.18	130	5.12	165105	165205
LM-6	52 – 65	2.05 – 2.56	392	15.4	38	1.50	150	5.90	165106	165206
LM-7	65 – 78	2.56 – 3.07	392	15.4	38	1.50	150	5.90	165107	165207
LM-8	78 – 90	3.07 – 3.55	392	15.4	38	1.50	150	5.90	165108	165208

Model	Set Range (Inch)	Code
SET: LM-16	0.51 – 2.56 (Model LM-1 to LM-6)	165116



Revolving Tail Stock Turrets

- Compact, accurate and well-made, these revolving tailstock turrets convert your engine or bench lathe into a screw machine
- Available in two sizes, have six holes each for holding six tools
- Trigger type handle is conveniently located which enables instant changing from one tool to another
- Supplied with Morse taper shank as indicated below

Turret Diameter (Inch)	Hole Size (Inch)	Morse Taper	Weight (lbs)	Code
2-1/2	5/8	2	4	303500
5	1	3	12	303501
5	1	4	12	303502
5	1	1" SS	12	303503

Tool Holder Bushings



CNC Bushings – Black Oxide Finish – Types C, CV, B, DD, J & Z

- For use on all NC and CNC turning machines to adapt a wide variety of boring bars, drills, reamers and other round shank type tools
- Heat treated and precision ground

Type C

- C bushings have long slots for clamping directly on the tool for positive alignment of the cutting edge of the tool

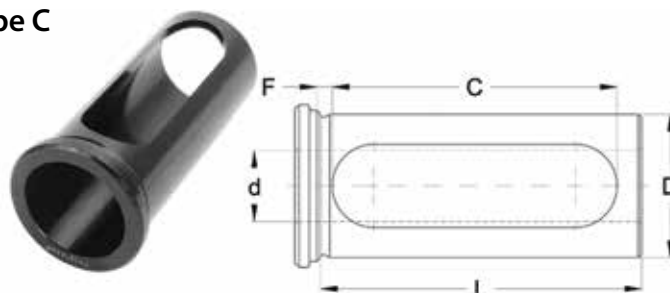

D Outside Diameter (Inch)	d Inside Diameter (Inch)	L Length Under Head (Inch)	C Slot Length (Inch)	F (Inch)	Code	D Outside Diameter (Inch)	d Inside Diameter (Inch)	L Length Under Head (Inch)	C Slot Length (Inch)	F (Inch)	Code	
3/4	3/8	2	1-1/2	0.1693	310732	1	3/4	2-3/4	2-3/8	0.1319	310540	
3/4	1/2	2	1-1/2	0.1693	310733	4 Piece Set – 3/8" to 3/4"					300851	
2 Piece Set – 3/8" to 1/2"						300850	1-1/4	3/8	3-1/4	2-3/4	0.1496	310544
1	3/8	2-3/4	2-3/8	0.1319	310534	1-1/4	1/2	3-1/4	2-3/4	0.1496	310545	
1	1/2	2-3/4	2-3/8	0.1319	310536	1-1/4	5/8	3-1/4	2-3/4	0.1496	310547	
1	5/8	2-3/4	2-3/8	0.1319	310538	1-1/4	3/4	3-1/4	2-3/4	0.1496	310549	