

## Mounted Flap Wheels

1/4" Shank (continued)

Size D x L (Inch)	Grit	RPM	Code	Size D x L (Inch)	Grit	RPM	Code	Size D x L (Inch)	Grit	RPM	Code
3 x 3/4	150	14000	705394	3 x 1	240	14000	705406	3 x 1-1/2	320	9000	705417
3 x 3/4	180	14000	705395	3 x 1	320	14000	705407	3 x 2	40	8000	705420
3 x 3/4	240	14000	705396	3 x 1-1/2	40	9000	705410	3 x 2	60	8000	705421
3 x 3/4	320	14000	705397	3 x 1-1/2	60	9000	705411	3 x 2	80	8000	705422
3 x 1	40	14000	705400	3 x 1-1/2	80	9000	705412	3 x 2	120	8000	705423
3 x 1	60	14000	705401	3 x 1-1/2	120	9000	705413	3 x 2	150	8000	705424
3 x 1	80	14000	705402	3 x 1-1/2	150	9000	705414	3 x 2	180	8000	705425
3 x 1	120	14000	705403	3 x 1-1/2	180	9000	705415	3 x 2	240	8000	705426
3 x 1	150	14000	705404	3 x 1-1/2	240	9000	705416	3 x 2	320	8000	705427
3 x 1	180	14000	705405								

## Mounted Points

General Purpose – W Shapes – 1/8", 1/4" & 3/8" Shanks

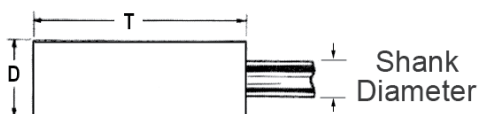
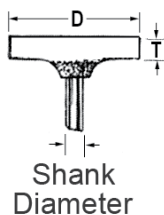

Style	Shank (Inch)	ØD (Inch)	T (Inch)	Code	Style	Shank (Inch)	ØD (Inch)	T (Inch)	Code
W141	1/8	3/32	5/32	725241	W162	1/4	1/4	3/8	718709
W142	1/8	3/32	1/4	725242	W163	1/8	1/4	1/2	725263
W143	1/8	1/8	1/8	725243	W163	1/4	1/4	1/2	718710
W144	1/8	1/8	1/4	725244	W164	1/8	1/4	3/4	725264
W145	1/8	1/8	3/8	725245	W164	1/4	1/4	3/4	718711
W145	1/4	1/8	3/8	718700	W165	1/8	5/16	1/16	725265
W146	1/8	1/8	1/2	725246	W165	1/4	5/16	1/16	718712
W147	1/8	5/32	1/32	725247	W166	1/8	5/16	1/8	725266
W148	1/8	5/32	1/16	725248	W167	1/8	5/16	1/4	725267
W149	1/8	5/32	1/4	725249	W168	1/8	5/16	5/16	725268
W149	1/4	5/32	1/4	718701	W169	1/8	5/16	3/8	725269
W150	1/8	3/16	1/16	725250	W169	1/4	5/16	3/8	718713
W151	1/8	3/16	1/8	725251	W170	1/8	5/16	1/2	725270
W152	1/8	3/16	1/4	725252	W170	1/4	5/16	1/2	718714
W152	1/4	3/16	1/4	718702	W171	1/8	5/16	3/4	725271
W153	1/8	3/16	3/8	725253	W172	1/8	3/8	1/16	725272
W153	1/4	3/16	3/8	718703	W173	1/8	3/8	1/8	725273
W154	1/8	3/16	1/2	725254	W173	1/4	3/8	1/8	718715
W154	1/4	3/16	1/2	718704	W174	1/8	3/8	1/4	725274
W155	1/8	13/64	1/4	725255	W174	1/4	3/8	1/4	718716
W155	1/4	13/64	1/4	718705	W175	1/8	3/8	3/8	725275
W156	1/8	1/4	1/32	725256	W175	1/4	3/8	3/8	718717
W157	1/8	1/4	1/16	725257	W176	1/8	3/8	1/2	725276
W157	1/4	1/4	1/16	718706	W176	1/4	3/8	1/2	718718
W158	1/8	1/4	1/8	725258	W177	1/8	3/8	3/4	725277
W159	1/8	1/4	3/16	725259	W177	1/4	3/8	3/4	718719
W160	1/8	1/4	1/4	725260	W178	1/8	3/8	1	725278
W160	1/4	1/4	1/4	718707	W178	1/4	3/8	1	718720
W161	1/8	1/4	5/16	725261	W180	1/8	1/2	1/32	725280
W161	1/4	1/4	5/16	718708	W181	1/8	1/2	1/16	725281
W162	1/8	1/4	3/8	725262	W181	1/4	1/2	1/16	718721