

## Combination Squares

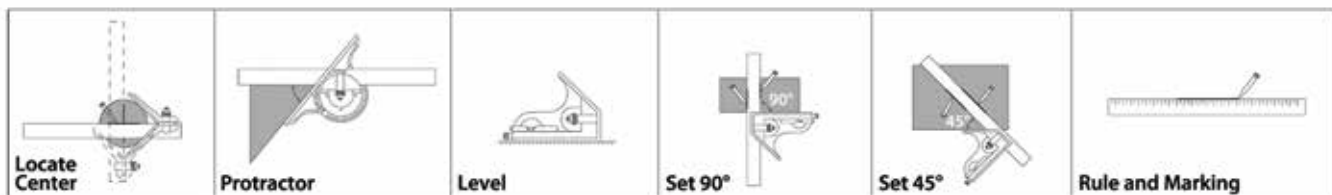
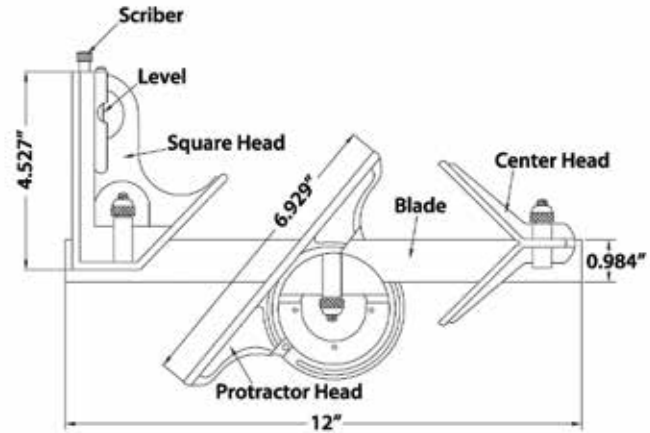
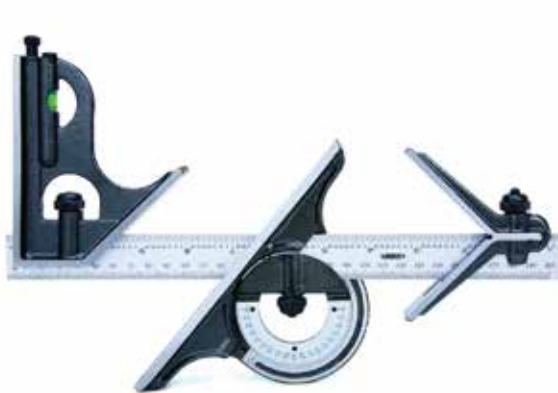

- Used as square, level, marking gage, scribe, center gage, protractor and 12" steel rule
- Center Head: to locate center of round workpieces - Accuracy:  $\pm 0.006"$
- Protractor Head: to set the blade at desired angle to an edge of a workpiece, and may be used to measure angles - Range: 0-180 °; Accuracy:  $\pm 7\text{min.}$
- Square Head: to set the blade at 90° or 45° to an edge of a workpiece - Accuracy:  $\pm 8\text{min.}$  for 90° square and  $\pm 10\text{min.}$  for 45° square
- Supplied in fitted storage case

OPTIONAL ACCESSORY:  
Rigid Rule 283006 (7113-300A)

Blade Length	Blade Graduation	INSIZE No.	Code
12"/300mm	1/32" and 0.5mm on one side, 1/64" and 1mm on reverse side	2278-180	816324
12"	1/8" and 1/16" on one side, 1/32" and 1/64" on reverse side	2278-180E	283344

## Double Square



- Accuracy:  $\pm 2\text{min}$  for 90° square
- Hardened and chrome plated blade

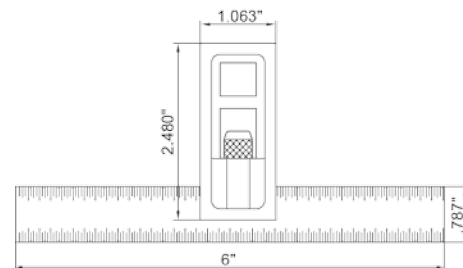

Blade Length	Blade Graduation	INSIZE No.	Code
6"	1/8", 1/16", 1/32", 1/64"	2277-2	283348

## Flat Edge Squares



- Meets DIN875 standards, grade 0
- Hardened stainless steel
- Supplied in fitted storage case

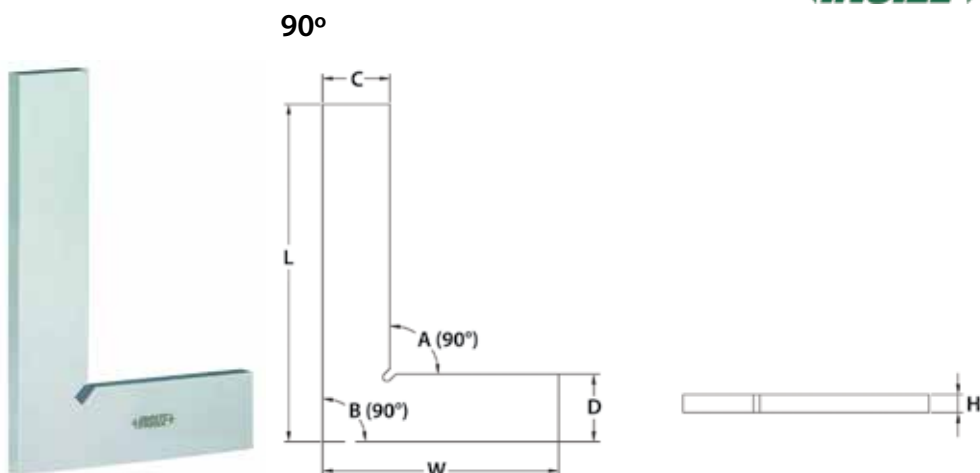

L x W Dimensions (Inch)	A Inside Squareness (Inch)	B Outside Squareness (Inch)	C (Inch)	D (Inch)	H (Inch)	INSIZE No.	Code
3.9 x 2.8	0.000276	0.000276	0.787	0.787	0.197	4791-100	816316
5.9 x 3.9	0.000276	0.000315	1.181	1.181	0.236	4791-150	816318

## Beveled Edge Squares



- Two beveled edges on upright blade for inside and outside measurements
- Hardened stainless steel
- Supplied in fitted storage case

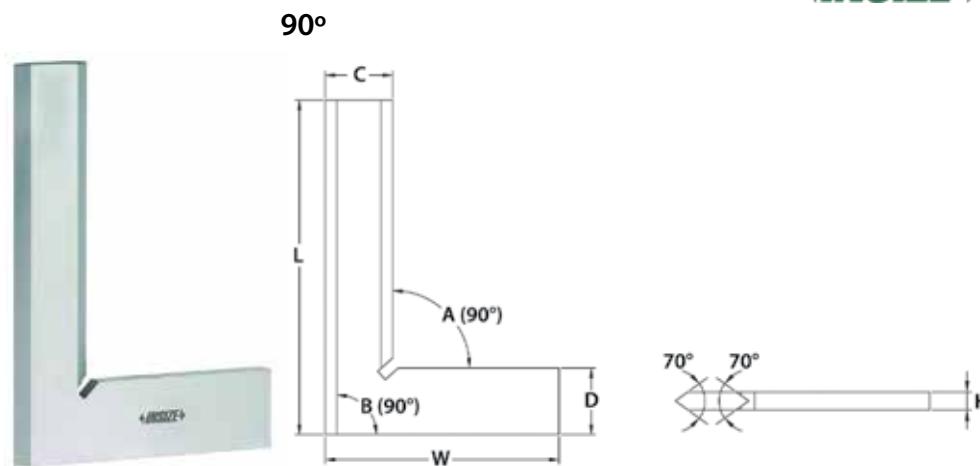

L x W Dimensions (Inch)	A Inside Squareness (Inch)	B Outside Squareness (Inch)	C (Inch)	D (Inch)	H (Inch)	INSIZE No.	Code
2.0 x 1.6	0.000094	0.000098	0.512	0.512	0.157	4790-050	816300
3.0 x 2.0	0.000102	0.000110	0.591	0.591	0.157	4790-075	816302
3.9 x 2.8	0.000110	0.000118	0.787	0.787	0.197	4790-0100	816304
5.9 x 3.9	0.000126	0.000138	1.181	1.181	0.236	4790-0150	816306
7.9 x 5.1	0.000146	0.000137	1.339	1.339	0.276	4790-0200	816308
11.8 x 7.9	0.000181	0.000197	1.575	1.575	0.315	4790-0300	816310

## Engineer's Precision Squares

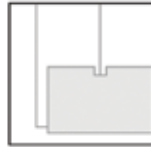
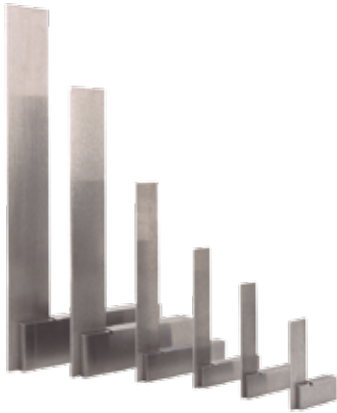

Stock is grooved at inner corner for clearance for burr or dirt so that there is no interference with measuring accuracies

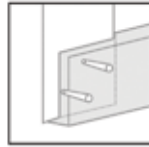

Use of tapered self locking rivets ensures perfect rigidity

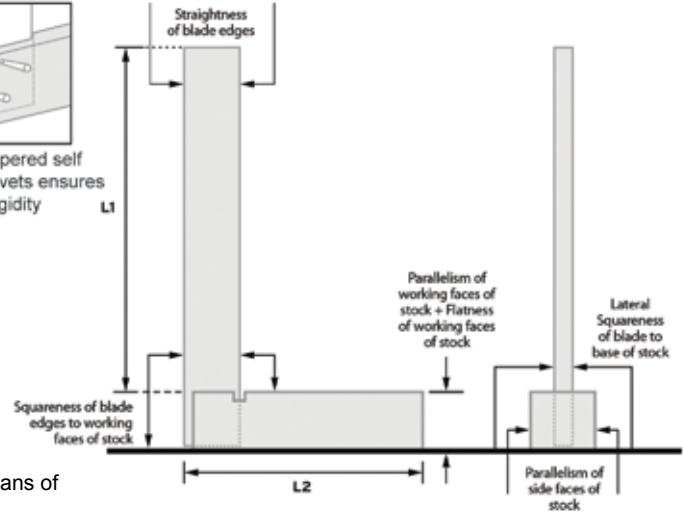

- Internal and external squareness as per BS 939 Grade B
- For setting up and checking jobs where extreme accuracy is required
- Hardened spring steel blades are permanently fixed to the stock by means of tapered self locking rivets which ensure complete rigidity
- Both blade and stock are precisely ground to ensure straightness and parallelism
- Working edges of blades are lapped which further enhance accuracy
- Groove on inner corner of stock aids in the clearance of burrs and dirt

L1 Blade Length (Inch)	L2 Stock Length (Inch)	Code
2	2	840562
3	2-3/8	840563
4	3	840564
6	4	840566
8	5	840568
12	8-9/32	840572



### Sets

Contents	Code
One each of 2", 3", 4" and 6" squares	840573
One each of 2", 4" and 6" squares	840574

## Center Squares

- Made from tool quality alloy steel
- Blade hardened and tempered
- Designed for fast and accurate location of the center of the face of a round bar or disc within the sizes listed
- A useful tool for machinists and toolmakers



Maximum Work Diameter (Inch)	Code
1-1/2	840580
3	840581