

## Mounted Flap Wheels

1/4" Shank

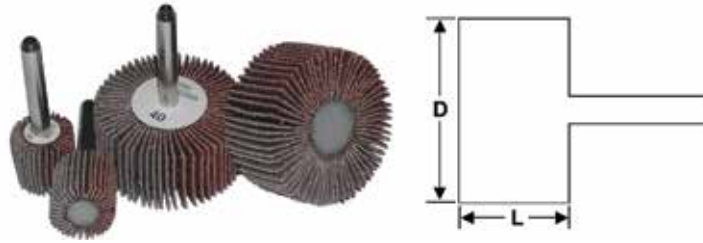

Size D x L (Inch)	Grit	RPM	Code	Size D x L (Inch)	Grit	RPM	Code	Size D x L (Inch)	Grit	RPM	Code
3/4 x 3/4	40	-	705180	1-1/2 x 3/4	240	18000	705246	2 x 1-1/2	60	17000	705321
3/4 x 3/4	60	-	705181	1-1/2 x 3/4	320	18000	705247	2 x 1-1/2	80	17000	705322
3/4 x 3/4	80	-	705182	1-1/2 x 1	40	18000	705260	2 x 1-1/2	120	17000	705323
3/4 x 3/4	120	-	705183	1-1/2 x 1	60	18000	705261	2 x 1-1/2	150	17000	705324
3/4 x 3/4	150	-	705184	1-1/2 x 1	80	18000	705262	2 x 1-1/2	180	17000	705325
3/4 x 3/4	180	-	705185	1-1/2 x 1	120	18000	705263	2 x 1-1/2	240	17000	705326
3/4 x 3/4	240	-	705186	1-1/2 x 1	150	18000	705264	2 x 1-1/2	320	17000	705327
3/4 x 3/4	320	-	705187	1-1/2 x 1	180	18000	705265	2-1/2 x 1/2	40	15000	705330
1 x 1	40	-	705190	1-1/2 x 1	240	18000	705266	2-1/2 x 1/2	60	15000	705331
1 x 1	60	-	705191	1-1/2 x 1	320	18000	705267	2-1/2 x 1/2	80	15000	705332
1 x 1	80	-	705192	2 x 3/8	40	17000	705270	2-1/2 x 1/2	120	15000	705333
1 x 1	120	-	705193	2 x 3/8	60	17000	705271	2-1/2 x 1/2	150	15000	705334
1 x 1	150	-	705194	2 x 3/8	80	17000	705272	2-1/2 x 1/2	180	15000	705335
1 x 1	180	-	705195	2 x 3/8	120	17000	705273	2-1/2 x 1/2	240	15000	705336
1 x 1	240	-	705196	2 x 3/8	150	17000	705274	2-1/2 x 1/2	320	15000	705337
1 x 1	320	-	705197	2 x 3/8	180	17000	705275	2-1/2 x 3/4	40	15000	705340
1-3/16 x 3/16	40	25000	705200	2 x 3/8	240	17000	705276	2-1/2 x 3/4	60	15000	705341
1-3/16 x 3/16	60	25000	705201	2 x 3/8	320	17000	705277	2-1/2 x 3/4	80	15000	705342
1-3/16 x 3/16	80	25000	705202	2 x 1/2	40	17000	705280	2-1/2 x 3/4	120	15000	705343
1-3/16 x 3/16	120	25000	705203	2 x 1/2	60	17000	705281	2-1/2 x 3/4	150	15000	705344
1-3/16 x 3/16	150	25000	705204	2 x 1/2	80	17000	705282	2-1/2 x 3/4	180	15000	705345
1-3/16 x 3/16	180	25000	705205	2 x 1/2	120	17000	705283	2-1/2 x 3/4	240	15000	705346
1-3/16 x 3/16	240	25000	705206	2 x 1/2	150	17000	705284	2-1/2 x 3/4	320	15000	705347
1-3/16 x 3/16	320	25000	705207	2 x 1/2	180	17000	705285	2-1/2 x 1	40	15000	705350
1-3/16 x 3/8	40	25000	705210	2 x 1/2	240	17000	705286	2-1/2 x 1	60	15000	705351
1-3/16 x 3/8	60	25000	705211	2 x 1/2	320	17000	705287	2-1/2 x 1	80	15000	705352
1-3/16 x 3/8	80	25000	705212	2 x 5/8	40	17000	705290	2-1/2 x 1	120	15000	705353
1-3/16 x 3/8	120	25000	705213	2 x 5/8	60	17000	705291	2-1/2 x 1	150	15000	705354
1-3/16 x 3/8	150	25000	705214	2 x 5/8	80	17000	705292	2-1/2 x 1	180	15000	705355
1-3/16 x 3/8	180	25000	705215	2 x 5/8	120	17000	705293	2-1/2 x 1	240	15000	705356
1-3/16 x 3/8	240	25000	705216	2 x 5/8	150	17000	705294	2-1/2 x 1	320	15000	705357
1-3/16 x 3/8	320	25000	705217	2 x 5/8	180	17000	705295	2-1/2 x 1-1/2	40	15000	705360
1-1/2 x 1/2	40	18000	705220	2 x 5/8	240	17000	705296	2-1/2 x 1-1/2	60	15000	705361
1-1/2 x 1/2	60	18000	705221	2 x 5/8	320	17000	705297	2-1/2 x 1-1/2	80	15000	705362
1-1/2 x 1/2	80	18000	705222	2 x 3/4	40	17000	705300	2-1/2 x 1-1/2	120	15000	705363
1-1/2 x 1/2	120	18000	705223	2 x 3/4	60	17000	705301	2-1/2 x 1-1/2	150	15000	705364
1-1/2 x 1/2	150	18000	705224	2 x 3/4	80	17000	705302	2-1/2 x 1-1/2	180	15000	705365
1-1/2 x 1/2	180	18000	705225	2 x 3/4	120	17000	705303	2-1/2 x 1-1/2	240	15000	705366
1-1/2 x 1/2	240	18000	705226	2 x 3/4	150	17000	705304	2-1/2 x 1-1/2	320	15000	705367
1-1/2 x 1/2	320	18000	705227	2 x 3/4	180	17000	705305	3 x 1/2	40	14000	705370
1-1/2 x 5/8	60	18000	705231	2 x 3/4	240	17000	705306	3 x 1/2	60	14000	705371
1-1/2 x 5/8	80	18000	705232	2 x 3/4	320	17000	705307	3 x 1/2	80	14000	705372
1-1/2 x 5/8	120	18000	705233	2 x 1	40	17000	705310	3 x 1/2	120	14000	705373
1-1/2 x 5/8	150	18000	705234	2 x 1	60	17000	705311	3 x 1/2	150	14000	705374
1-1/2 x 5/8	180	18000	705235	2 x 1	80	17000	705312	3 x 1/2	180	14000	705375
1-1/2 x 3/4	40	18000	705240	2 x 1	120	17000	705313	3 x 1/2	240	14000	705376
1-1/2 x 3/4	60	18000	705241	2 x 1	150	17000	705314	3 x 1/2	320	14000	705377
1-1/2 x 3/4	80	18000	705242	2 x 1	180	17000	705315	3 x 3/4	40	14000	705390
1-1/2 x 3/4	120	18000	705243	2 x 1	240	17000	705316	3 x 3/4	60	14000	705391
1-1/2 x 3/4	150	18000	705244	2 x 1	320	17000	705317	3 x 3/4	80	14000	705392
1-1/2 x 3/4	180	18000	705245	2 x 1-1/2	40	17000	705320	3 x 3/4	120	14000	705393

## Mounted Flap Wheels

1/4" Shank (continued)

Size D x L (Inch)	Grit	RPM	Code	Size D x L (Inch)	Grit	RPM	Code	Size D x L (Inch)	Grit	RPM	Code
3 x 3/4	150	14000	705394	3 x 1	240	14000	705406	3 x 1-1/2	320	9000	705417
3 x 3/4	180	14000	705395	3 x 1	320	14000	705407	3 x 2	40	8000	705420
3 x 3/4	240	14000	705396	3 x 1-1/2	40	9000	705410	3 x 2	60	8000	705421
3 x 3/4	320	14000	705397	3 x 1-1/2	60	9000	705411	3 x 2	80	8000	705422
3 x 1	40	14000	705400	3 x 1-1/2	80	9000	705412	3 x 2	120	8000	705423
3 x 1	60	14000	705401	3 x 1-1/2	120	9000	705413	3 x 2	150	8000	705424
3 x 1	80	14000	705402	3 x 1-1/2	150	9000	705414	3 x 2	180	8000	705425
3 x 1	120	14000	705403	3 x 1-1/2	180	9000	705415	3 x 2	240	8000	705426
3 x 1	150	14000	705404	3 x 1-1/2	240	9000	705416	3 x 2	320	8000	705427
3 x 1	180	14000	705405								

## Mounted Points

General Purpose – W Shapes – 1/8", 1/4" & 3/8" Shanks

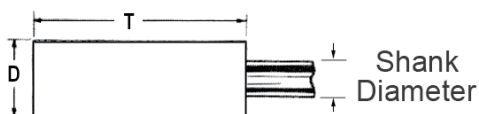
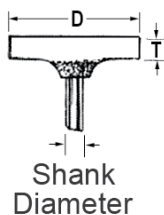

Style	Shank (Inch)	ØD (Inch)	T (Inch)	Code	Style	Shank (Inch)	ØD (Inch)	T (Inch)	Code
W141	1/8	3/32	5/32	725241	W162	1/4	1/4	3/8	718709
W142	1/8	3/32	1/4	725242	W163	1/8	1/4	1/2	725263
W143	1/8	1/8	1/8	725243	W163	1/4	1/4	1/2	718710
W144	1/8	1/8	1/4	725244	W164	1/8	1/4	3/4	725264
W145	1/8	1/8	3/8	725245	W164	1/4	1/4	3/4	718711
W145	1/4	1/8	3/8	718700	W165	1/8	5/16	1/16	725265
W146	1/8	1/8	1/2	725246	W165	1/4	5/16	1/16	718712
W147	1/8	5/32	1/32	725247	W166	1/8	5/16	1/8	725266
W148	1/8	5/32	1/16	725248	W167	1/8	5/16	1/4	725267
W149	1/8	5/32	1/4	725249	W168	1/8	5/16	5/16	725268
W149	1/4	5/32	1/4	718701	W169	1/8	5/16	3/8	725269
W150	1/8	3/16	1/16	725250	W169	1/4	5/16	3/8	718713
W151	1/8	3/16	1/8	725251	W170	1/8	5/16	1/2	725270
W152	1/8	3/16	1/4	725252	W170	1/4	5/16	1/2	718714
W152	1/4	3/16	1/4	718702	W171	1/8	5/16	3/4	725271
W153	1/8	3/16	3/8	725253	W172	1/8	3/8	1/16	725272
W153	1/4	3/16	3/8	718703	W173	1/8	3/8	1/8	725273
W154	1/8	3/16	1/2	725254	W173	1/4	3/8	1/8	718715
W154	1/4	3/16	1/2	718704	W174	1/8	3/8	1/4	725274
W155	1/8	13/64	1/4	725255	W174	1/4	3/8	1/4	718716
W155	1/4	13/64	1/4	718705	W175	1/8	3/8	3/8	725275
W156	1/8	1/4	1/32	725256	W175	1/4	3/8	3/8	718717
W157	1/8	1/4	1/16	725257	W176	1/8	3/8	1/2	725276
W157	1/4	1/4	1/16	718706	W176	1/4	3/8	1/2	718718
W158	1/8	1/4	1/8	725258	W177	1/8	3/8	3/4	725277
W159	1/8	1/4	3/16	725259	W177	1/4	3/8	3/4	718719
W160	1/8	1/4	1/4	725260	W178	1/8	3/8	1	725278
W160	1/4	1/4	1/4	718707	W178	1/4	3/8	1	718720
W161	1/8	1/4	5/16	725261	W180	1/8	1/2	1/32	725280
W161	1/4	1/4	5/16	718708	W181	1/8	1/2	1/16	725281
W162	1/8	1/4	3/8	725262	W181	1/4	1/2	1/16	718721

## Mounted Points

General Purpose – W Shapes – 1/8", 1/4" & 3/8" Shanks (continued)

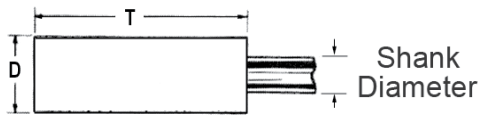
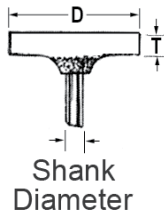

Style	Shank (Inch)	ØD (Inch)	T (Inch)	Code	Style	Shank (Inch)	ØD (Inch)	T (Inch)	Code
W182	1/8	1/2	1/8	725282	W210	1/4	7/8	1/16	718742
W182	1/4	1/2	1/8	718722	W211	1/8	7/8	1/8	725311
W183	1/8	1/2	1/4	725283	W211	1/4	7/8	1/8	718743
W183	1/4	1/2	1/4	718723	W212	1/8	7/8	1/4	725312
W184	1/8	1/2	3/8	725284	W212	1/4	7/8	1/4	718744
W184	1/4	1/2	3/8	718724	W213	1/8	7/8	3/8	725313
W185	1/8	1/2	1/2	725285	W213	1/4	7/8	3/8	718745
W185	1/4	1/2	1/2	718725	W214	1/8	15/16	1/4	725314
W186	1/8	1/2	3/4	725286	W214	1/4	15/16	1/4	718746
W186	1/4	1/2	3/4	718726	W215	1/8	1	1/8	725315
W187	1/8	1/2	1	725287	W215	1/4	1	1/8	718747
W187	1/4	1/2	1	718727	W216	1/8	1	1/4	725316
W190	1/8	5/8	1/16	725290	W216	1/4	1	1/4	718748
W191	1/8	5/8	1/8	725291	W218	1/4	1	1/2	725318
W191	1/4	5/8	1/8	718728	W219	1/4	1	3/4	725319
W192	1/8	5/8	1/4	725292	W220	1/4	1	1	725320
W192	1/4	5/8	1/4	718729	W221	1/4	1	1-1/2	725321
W193	1/8	5/8	3/8	725293	W222	1/4	1	2	725322
W193	1/4	5/8	3/8	718730	W223	1/4	1	2-1/2	725323
W194	1/8	5/8	1/2	725294	W224	1/4	1	3	725324
W194	1/4	5/8	1/2	718731	W224	3/8	1	3	718771
W195	1/8	5/8	3/4	725295	W225	1/4	1-1/4	1/4	725325
W195	1/4	5/8	3/4	718732	W226	1/4	1-1/4	3/8	725326
W196	1/8	5/8	1	725296	W227	1/4	1-1/4	1/2	725327
W198	1/4	5/8	2-1/2	718733	W228	1/4	1-1/4	3/4	725328
W199	1/8	3/4	1/16	725299	W229	1/4	1-1/4	1	725329
W199	1/4	3/4	1/16	718734	W230	1/4	1-1/4	1-1/4	725330
W200	1/8	3/4	1/8	725300	W231	1/4	1-1/4	1-1/2	725331
W200	1/4	3/4	1/8	718735	W232	1/4	1-1/4	2	718764
W201	1/8	3/4	1/4	725301	W233	3/8	1-1/4	2-1/2	718772
W201	1/4	3/4	1/4	718736	W234	3/8	1-1/4	3	718773
W202	1/8	3/4	3/8	725302	W235	1/4	1-1/2	1/4	725335
W202	1/4	3/4	3/8	718737	W236	1/4	1-1/2	1/2	725336
W203	1/8	3/4	1/2	725303	W237	1/4	1-1/2	1	725337
W203	1/4	3/4	1/2	718738	W238	1/4	1-1/2	1-1/2	718768
W204	1/8	3/4	3/4	725304	W239	1/4	1-1/2	2	718769
W204	1/4	3/4	3/4	718739	W239	3/8	1-1/2	2	718774
W205	1/8	3/4	1	725305	W240	3/8	1-1/2	2-1/2	718775
W205	1/4	3/4	1	718740	W241	1/4	1-1/2	3	725341
W210	1/8	7/8	1/16	725310	W241	3/8	1-1/2	3	718776

## Mounted Points

General Purpose – A Shapes – 1/4" Shank



Shape	Shank (Inch)	ØD (Inch)	Length (Inch)	Code
A1	1/4	3/4	2-1/2	725101
A2	1/4	1	1-1/4	725102
A3	1/4	1	2-3/4	725103
A4	1/4	1-1/4	1-1/4	725104
A5	1/4	3/4	1-1/8	725105
A6	1/4	3/4	1-1/8	725106
A11	1/4	7/8	2	725111
A12	1/4	11/16	1-1/4	725112
A13	1/4	1-1/8	1-1/8	725113
A14	1/4	11/16	7/8	725114
A15	1/4	1/4	1-1/16	725115
A21	1/4	1	1	725121
A22	1/4	3/4	5/8	725122
A23	1/4	3/4	1	725123

Shape	Shank (Inch)	ØD (Inch)	Length (Inch)	Code
A24	1/4	1/4	3/4	725124
A25	1/4	1	-	725125
A26	1/4	5/8	-	725126
A31	1/4	1-3/8	1	725131
A32	1/4	1	5/8	725132
A33	1/4	1	1/2	725133
A34	1/4	1-1/2	3/8	725134
A35	1/4	1	3/8	725135
A36	1/4	1-5/8	3/8	725136
A37	1/4	1-1/4	1/4	725137
A38	1/4	1	1	725138
A39	1/4	3/4	3/4	725139
A40	1/4	3/4	-	725140

## Mounted Points

General Purpose – B Shapes – 1/8" & 1/4" Shanks



Shape	Shank (Inch)	ØD (Inch)	Length (Inch)	Code	Shape	Shank (Inch)	ØD (Inch)	Length (Inch)	Code
B41	1/8	5/8	5/8	725141	B51	1/4	7/16	3/4	718782
B41	1/4	5/8	5/8	718777	B52	1/8	3/8	3/4	725152
B42	1/8	1/2	3/4	725142	B52	1/4	3/8	3/4	718783
B42	1/4	1/2	3/4	718778	B53	1/8	1/4	5/8	725153
B43	1/8	1/4	5/16	725143	B53	1/4	1/4	5/8	718784
B43	1/4	1/4	5/16	718779	B54	1/8	1/4	1/2	725154
B44	1/8	7/32	3/8	725144	B54	1/4	1/4	1/2	718785
B44	1/4	7/32	3/8	718780	B55	1/8	1/8	1/4	725155
B45	1/8	3/16	5/16	725145	B61	1/8	3/4	5/16	725161
B45	1/4	3/16	5/16	718781	B61	1/4	3/4	5/16	718786
B46	1/8	1/8	5/16	725146	B62	1/8	1/2	3/8	725162
B47	1/8	1/8	5/32	725147	B62	1/4	1/2	3/8	718787
B51	1/8	7/16	3/4	725151	B63	1/8	1/4	3/16	725163

## Mounted Points

### General Purpose – B Shapes – 1/8" & 1/4" Shanks (continued)

Shape	Shank (Inch)	ØD (Inch)	Length (Inch)	Code	Shape	Shank (Inch)	ØD (Inch)	Length (Inch)	Code
B63	1/4	1/4	3/16	718788	B103	1/4	5/8	1/4	718801
B64	1/8	1/4	1/16	725164	B104	1/8	5/16	3/8	725204
B65	1/8	1/8	1/8	725165	B104	1/4	5/16	3/8	718802
B71	1/8	5/8	1/8	725171	B105	1/8	1/4	1/4	725205
B71	1/4	5/8	1/8	718789	B105	1/4	1/4	1/4	718803
B72	1/8	1/2	1/8	725172	B106	1/8	1/8	7/64	725206
B72	1/4	1/2	1/8	718790	B111	1/8	7/16	11/16	725211
B73	1/8	1/2	1/8	725173	B111	1/4	7/16	11/16	718804
B73	1/4	1/2	1/8	718791	B112	1/8	3/8	1/2	725212
B74	1/8	7/32	3/32	725174	B112	1/4	3/8	1/2	718805
B81	1/8	3/4	3/16	725181	B113	1/8	1/4	1/4	725213
B81	1/4	3/4	3/16	718792	B113	1/4	1/4	1/4	718806
B82	1/8	1/2	1/4	725182	B114	1/8	7/32	3/8	725214
B82	1/4	1/2	1/4	718793	B114	1/4	7/32	3/8	718807
B83	1/8	3/8	3/16	725183	B115	1/8	1/8	3/32	725215
B84	1/8	5/16	3/16	725184	B121	1/8	1/2	-	725221
B84	1/4	5/16	3/16	718794	B121	1/4	1/2	-	718808
B90	1/8	1/2	1/2	725190	B122	1/8	3/8	-	725222
B90	1/4	1/2	1/2	718795	B122	1/4	3/8	-	718809
B91	1/8	1/2	5/8	725191	B123	1/8	3/16	-	725223
B91	1/4	1/2	5/8	718796	B123	1/4	3/16	-	718810
B92	1/8	1/4	1/4	725192	B124	1/8	1/8	-	725224
B92	1/4	1/4	1/4	718797					
B93	1/8	3/16	3/16	725193	B131	1/8	1/2	1/2	725231
B93	1/4	3/16	3/16	718798	B131	1/4	1/2	1/2	718811
B94	1/8	11/64	3/32	725194	B132	1/8	3/8	1/2	725232
B95	1/8	1/8	3/16	725195	B132	1/4	3/8	1/2	718812
B96	1/8	1/8	1/4	725196	B133	1/8	3/8	3/8	725233
B97	1/8	1/8	3/8	725197	B133	1/4	3/8	3/8	718813
B98	1/8	3/32	1/4	725198	B134	1/8	5/16	3/8	725234
B101	1/8	5/8	11/16	725201	B134	1/4	5/16	3/8	718814
B101	1/4	5/8	11/16	718799	B135	1/8	1/4	1/2	725235
B102	1/8	5/8	1/2	725202	B135	1/4	1/4	1/2	718815
B102	1/4	5/8	1/2	718800	B136	1/8	1/4	5/16	725236
B103	1/8	5/8	1/4	725203	B136	1/4	1/4	5/16	718816