

## Industrial Drill Chucks & Key

**LLAMBRICH**

### For Stationary & Portable Drilling Machines



- Specifically designed for stationary drilling, turning, milling and wood working machines
- The one-piece gear ring and sleeve eliminate the possibility of tooth breakage
- The jaws, gear ring and body are all totally hardened to avoid wear and lengthen the life of the drill chuck
- Fits tools of up to 19mm (3/4") in diameter
- Machine fitting via DIN238 of JACOBS tapers and UNF screw fittings
- Wide range of accessories

Model	Capacity (mm)	Capacity (Inch)	Mount	Diameter (mm)	Length Closed (mm)	Length Open (mm)	Weight (g)	Code
CY-04 J0	0.8-4	1/64-5/32	J-0	22	29	36	100	827812
CY-04 R-5/16	0.8-4	1/32-5/32	5/16" x 24	22	38	44	130	827826
CY-06 J-1	0.8-6.5	1/32-1/4	J-1	32	40	49	200	827813
CY-06 R-3/8	0.8-6.5	1/32-1/4	3/8" x 24	32	42	52	220	827821
*CY-06 R-3/8 SP	0.8-6.5	1/32-1/4	3/8" x 24	37	51	63	340	827827
CY-10 J-1	1-10	1/32-3/8	J-1	37	51	60	310	827815
CY-10 J-2	1-10	1/32-3/8	J-2	37	51	60	300	827816
*CY-10 J-2 SP	1-10	1/32-3/8	J-2	43	55	68	420	827814
CY-10 R-3/8	1-10	1/32-3/8	3/8" x 24	37	51	60	300	827829
*CY-10 R-3/8 SP	1-10	1/32-3/8	3/8" x 24	43	53	68	420	827828
CY-10 R-1/2	1-10	1/32-3/8	1/2" x 20	37	51	60	300	827822
*CY-10 R-1/2 SP	1-10	1/32-3/8	1/2" x 20	43	53	68	420	827831
CY-13 J-6	1-13	1/32-1/2	J-6	46	62	77	480	827806
CY-13 J-33	1-13	1/32-1/2	J-33	46	62	77	480	827817
CY-13 J-33 KD (1)	1-13	1/32-1/2	33JT	46	71	86	500	827819
CY-13 R-3/8	1-13	1/32-1/2	3/8" x 24	46	62	77	500	827833
CY-13 R-1/2	1-13	1/32-1/2	1/2" x 20	46	62	77	480	827832
CY-13 R-5/8	1-13	1/32-1/2	5/8" x 16	46	62	77	490	827834
*CYX-13 J-2	1-13	1/32-1/2	J-2	53	69	89	760	827805
*CYX-13 J-33	1-13	1/32-1/2	J-33	53	69	89	750	827807
CYX-13 J-33C (3)	1-13	1/32-1/2	33JT	53	86	106	820	827808
<b>CY-16 J-33</b>	<b>1-16</b>	<b>1/32-5/8</b>	<b>J-33</b>	<b>57</b>	<b>77</b>	<b>95</b>	<b>980</b>	<b>348126</b>
CY-16 J-3	1-16	1/32-5/8	J-3	57	77	95	940	348118
CY-16 J-3 KD (1)	1-16	1/32-5/8	3JT	57	85	102	980	827803
CY-16 J-3 PD (2)	1-16	1/32-5/8	3JT	57	85	102	980	827804
CY-16 R-1/2	1-16	1/32-5/8	1/2" x 20	57	77	95	990	827823
CY-16 R-5/8	1-16	1/32-5/8	5/8" x 16	57	77	95	1,000	827820
CY-19 J-3	3-19	13/64-3/4	J-3	65	85	110	1,440	827809
CY-19 J-3 KD (1)	3-19	13/64-3/4	3JT	65	89	116	1,400	827810
CY-19 J-3 PD (2)	3-19	13/64-3/4	3JT	65	89	116	1,360	827811
CY-19 J-4	3-19	13/64-3/4	J-4	68	97	120	1,500	348132
CY-19 R-3/4	3-19	13/64-3/4	3/4" x 16	65	85	110	1,500	348130

\* Extra heavy duty model

(1) Equipped with positive drive slot

(2) Equipped with pin type positive drive

(3) Equipped with locking collar

### Ball-Bearing Drill Chucks & Key

#### For Production Drilling Equipment



- Drill chuck with key for industrial applications that require the toughest machining conditions
- Equipped with ball bearings to reduce friction in the tightening mechanism and provide a better grip on the drill shaft
- All the pieces are hardened and ground
- The one-piece gear ring and sleeve eliminate the possibility of tooth breakage
- Fits tools up to 25mm (1")
- Machine fitting via JACOBS taper

Model	Capacity (mm)	Capacity (Inch)	Mount	Diameter (mm)	Length Closed (mm)	Length Open (mm)	Weight (g)	Code
CBB-08 J2	1-8	1/32-5/16	J-2	47	55	70	500	348141
CBB-10 J2	1-10	1/32-3/8	J-2	47	55	70	500	348142
CBB-13 J3	1-13	1/32-1/2	J-3	62	75	94	1,115	348144
CBB-16 J3	1-16	1/32-5/8	J-3	67	81	102	1,470	348145
CBB-19 J4	1-19	1/32-3/4	J-4	75	99	125	2,145	348146
CBB-25 J5	5-25	13/64-1	J-5	93	112	147	3,645	348147

### Chuck Keys

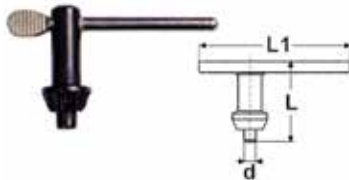

Key	Jacobs Key Reference	d (mm)	L (mm)	L1 (mm)	Code
S8	K30	6.00	41	80	348148
S9	K32	6.35	45	83	348149
S10	K3	8.00	48	100	348150
S13	K4	9.50	70	110	348208

### Chuck Keys



Model	Code	Model	Code
K0	350K0	K4	350K4
K1	350K1	K5	350K5
K2	350K2	K7	350K7
K3	350K3	K30	350K30
		K32	350K32

## Keyless Drill Chucks

**ALBRECHT**

### Classic



- Keyless operation
- Self-tightening design
- Balanced

Capacity (Inch)	Capacity (mm)	Mount	Maximum RPM	Weight (lbs)	Code
0 - 1/16	0 - 1.5	J0	50000	0.1	827901
0 - 1/8	0 - 3	J0	35000	0.2	827902
0 - 1/8	0 - 3	J1	35000	0.2	827903
0 - 1/4	0 - 6.5	J1	20000	0.7	827904
0 - 3/8	0 - 10	J33	12000	1.4	827905
0 - 3/8	0 - 10	J2	12000	1.4	827906
1/32 - 1/2	1 - 13	J33	7000	2.1	827907
1/32 - 1/2	1 - 13	J2	7000	2.1	827908
1/32 - 1/2	1 - 13	J6	7000	2.1	827909
1/8 - 5/8	3 - 16	J6	4000	2.8	827910

## Keyless Drill Chucks

**LAMBRICH**

### For Portable Drilling Machines



- Ideal for portable electric or battery operated drilling machines
- Does not require a chuck key for tightening or loosening, enabling production increase
- Ergonomic design, using materials which eliminate the possibility of oxidation
- Fits any type of drill, via UNF thread, male and female
- Wide range of accessories

Model	Capacity (mm)	Capacity (Inch)	Mount	Diameter (mm)	Length Closed (mm)	Length Open (mm)	Weight (g)	Code
CPL-10 R-3/8	1-10	1/32-3/8	3/8" x 24 UNF	41	57	65	180	348134
CPL-10 R-1/2	1-10	1/32-3/8	1/2" x 20 UNF	41	57	65	180	348136

## Threaded Mount for Portable Drilling Machines & Taper Mount for Stationary Machines



- Standard screw thread mount for portable drilling machines
- Standard tapered mount for stationary drilling machines
- Self-tightening mechanism automatically increases the clamping forces in proportion to the increase in torque during the drilling operation. This prevents tool slippage in clockwise rotation.
- Tool capacity of up to 3/4" in diameter

### Threaded Mount

Model	Capacity (Inch)	Mount	Diameter (Inch)	Length Closed (Inch)	Length Open (Inch)	Code
L40165B	1/32 - 3/8	3/8 - 24	1.457	2.835	3.071	348209
L40166B	1/32 - 3/8	1/2 - 20	1.457	2.835	3.071	348210
L40171B	1/16 - 1/2	3/8 - 24	1.575	2.992	3.268	348211
L40172B	1/16 - 1/2	1/2 - 20	1.575	2.992	3.268	348212

### Taper Mount

Model	Capacity (Inch)	Jacobs Mount	Diameter (Inch)	Length Closed (Inch)	Length Open (Inch)	Code
L40159B	1/64 - 1/4	JT1	1.339	2.480	2.756	348213
L40163B	1/32 - 5/16	JT1	1.457	2.835	3.071	348214
L40164B	1/32 - 5/16	JT2	1.457	2.835	3.071	348215
L40167B	1/32 - 3/8	JT2	1.575	3.110	3.386	348216
L40221B	1/32 - 3/8	JT33	1.575	3.110	3.386	348217
L40168B	1/32 - 1/2	JT2	1.850	3.661	4.055	348218
L40169B	1/32 - 1/2	JT33	1.850	3.661	4.055	348219
L40170B	1/32 - 1/2	JT6	1.850	3.661	4.055	348220
L40173B	1/8 - 5/8	JT33	2.047	3.740	4.134	348221
L40174B	1/8 - 5/8	JT6	2.047	3.740	4.134	348222
L40177B	3/16 - 3/4	JT3	2.520	4.764	5.157	348223

## Keyless Drill Chucks with Locking Mechanism

**LLAMBRICH**

### Plastic Body & Carbide Jaw Inserts



- With a locking mechanism, no key is required for closing or opening, for hammer drilling and also screwdriver operations
- Carbide jaw inserts (for 13mm capacity) reduce bit slippage and enhance wear resistance
- Ergonomic design, using materials that eliminate the possibility of rust
- With through hole for clockwise and counter-clockwise rotation
- Supplied with screw M5 (R-3/8") or M6 (R-1/2") to fix chuck to drilling machine
- Fits any type of drill (up to 1000W) via UNF thread, male and female
- Wide range of accessories

Model	Capacity (mm)	Capacity (Inch)	Mount	Diameter (mm)	Length Closed (mm)	Length Open (mm)	Weight (g)	Code
CPX-13 R-3/8	2-13	1/16-1/2	3/8" x 24 UNF	42	65	75	280	348138
CPX-13 R-1/2	2-13	1/16-1/2	1/2" x 20 UNF	42	65	75	280	348140

## Precision Keyless Drill Chucks



Capacity (Inch)	Mount	Code
0 - 1/4	J1	354100
0 - 1/4	3/8-24	354102
0 - 3/8	J2	354106
0 - 3/8	3/8-24	354108
1/32 - 1/2	J6	354112
1/32 - 1/2	J33	354114
1/32 - 1/2	1/2-20	354116
1/8 - 5/8	J6	354120
1/8 - 5/8	5/8-16	354122

## Super Precision Keyless Drill Chucks

**LLAMBRICH**



- Maximum total integrated run-out of 0.04mm
- Self-tightening feature automatically increases gripping force in proportion to increased torque to prevent tool shank slippage (for right-hand rotation applications only)
- Permits use on high accuracy drill presses, jig borers, milling machines and production drilling equipment
- All components exposed to wear are completely hardened to maintain accuracy and extend chuck life
- Also available with through hole for EDM machines upon request

Model	Capacity (mm)	Capacity (Inch)	Mount	Diameter (mm)	Length Closed (mm)	Length Open (mm)	Weight (g)	Code
SP-1.5 J-0	0.2-1.5	0.0008-1/16	J-0	19.4	35	37.3	80	827841
SP-03 J-0	0.3-3	1/64-1/8	J-0	24.5	44	47.5	200	827842
SP-03 J-1	0.3-3	1/64-1/8	J-1	24.5	44	47.5	200	827843
SP-06 J-1	0.3-6.5	1/64-1/4	J-1	33	62	70	360	351099
SP-08 J-1	0.3-8	1/64-5/16	J-1	38	67	74	460	351100
SP-08 J-25	0.3-8	1/64-5/16	J-25	38	67	74	460	351102
SP-10 J-2	0.5-10	1/32-3/8	J-2	43	81	89	720	351104
SP-10 J-33	0.5-10	1/32-3/8	J-33	43	81	89	720	351106
SP-13 J-2	1-13	1/32-1/2	J-2	49	91	103	1,000	351108
SP-13 J-33	1-13	1/32-1/2	J-33	49	91	103	1,000	351110
SP-13 J-6	1-13	1/32-1/2	J-6	49	91	103	1,000	351112
SP-16 J-6	3-16	1/8-5/8	J-6	55	95	107	1,320	351114

## Integral Shank Drill Chucks



- Rigid heavy duty design
- High accuracy and high RPM
- Wide gripping capacity
- Self tightening keyless operations
- Provided with wrenches
- Non-coolant through
- Taper shank ground to AT3 accuracy or better

### CAT40 & CAT50

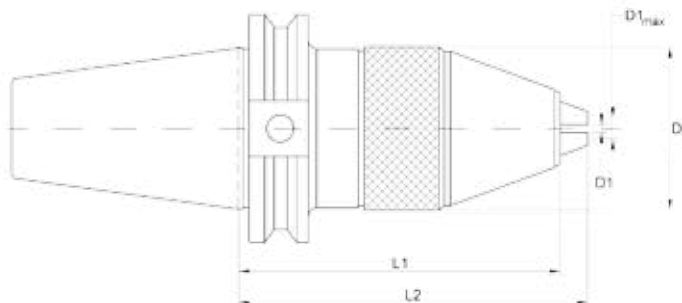

- CAT40 draw bar threads: 5/8"-11
- CAT50 draw bar threads: 1"-8
- Max. T.I.R. 0.0004"

Chuck Size (Inch)	D1 Min-Max (Inch)	L1 (Inch)	L2 (Inch)	Wrench Reference	CAT40			CAT50		
					D2 (Inch)	Weight (lbs)	Code	D2 (Inch)	Weight (lbs)	Code
1/2	0.039-0.512	4.04	4.50	312189	1.89	3.84	310939	1.98	7.85	312028

### BT40 & BT50

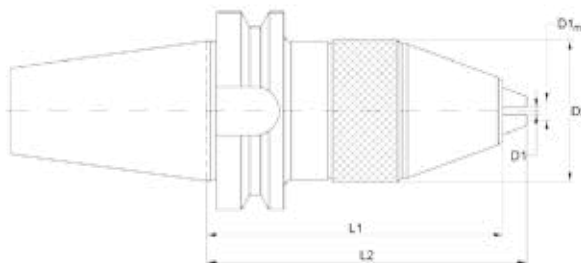

- BT40 draw bar threads: M16 x 2
- BT50 draw bar threads: M24 x 3

Chuck Size (Inch)	D1 Min-Max (Inch)	L1 (Inch)	L2 (Inch)	Wrench Reference	BT40			BT50		
					D2 (Inch)	Weight (lbs)	Code	D2 (Inch)	Weight (lbs)	Code
1/2	0.039-0.512	3.795	4.272	312189	1.988	3.97	310862	-	-	-
1/2	0.039-0.512	4.346	4.823	312189	-	-	-	1.988	9.70	310903

## Keyless Drill Chucks with Integral Shanks

**ALBRECHT**

### Classic-Plus



- Integral shank design is more compact than a combined drill chuck and arbor, resulting in greater accuracy, greater rigidity and a larger work envelope
- Integral shank eliminates the possibility of a chuck slipping on its arbor
- Keyless operation
- Self-tightening
- Balanced

Model	Capacity (mm)	Capacity (Inch)	Mount	Diameter (Inch)	Length Closed (Inch)	Length Open (Inch)	Weight (lbs)	Code
CP130-2MT	1 - 13	1/32 - 1/2	MT2	2	3-3/8	3-7/8	2.3	827911
CP130-3MT	1 - 13	1/32 - 1/2	MT3	2	3-3/8	3-7/8	2.6	827912
CP130-4MT	1 - 13	1/32 - 1/2	MT4	2	3-7/16	3-15/16	3.3	827913
CP130-R8	1 - 13	1/32 - 1/2	R8	2	3-5/16	3-13/16	2.6	827914
CP130-5/8	1 - 13	1/32 - 1/2	5/8" SS	2	3-1/8	3-5/8	2.2	827915
CP160-2MT	3 - 16	1/8 - 5/8	MT2	2-1/4	3-1/2	4-1/16	2.9	827916
CP160-3MT	3 - 16	1/8 - 5/8	MT3	2-1/4	3-1/2	4-1/16	3.3	827917
CP160-4MT	3 - 16	1/8 - 5/8	MT4	2-1/4	3-9/16	4-1/16	4.0	827918
CP160-R8	3 - 16	1/8 - 5/8	R8	2-1/4	3-7/16	3-15/16	4.2	827919



## Micro-Sensitive Drill Feed Adapter

- Micro-sensitive drill adapter only - chuck and drill sold separately
- 3/4" travel
- Simple to use: - Grasp free-turning knurled ring and feed with gentle finger pressure  
- Spring-loaded - when ring is released, chuck retracts automatically
- Sensitive drill feeds makes drilling of small holes easy by giving you fingertip feed control independent of coarser quill feed
- Makes drilling of small holes easy by giving you fingertip feed control
- Eliminates the need for special machines to drill small holes
- Reduces breakage and deflection of small drills

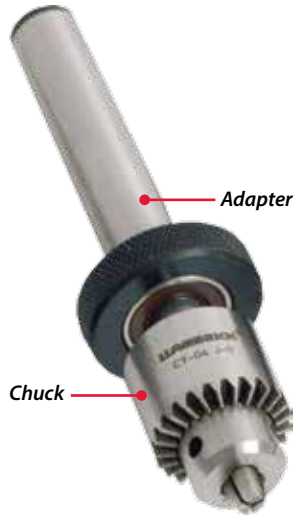

Shank Diameter (Inch)	Jacobs Taper	Code
1/2	JT0	820383

## Micro Drill Chuck & Key

**LLAMBRICH**

- Very accurate and sensitive for precise drilling
- To be used in mills, lathes, drill presses, jig bore and Swiss machines
- Eliminates the need of secondary operations to drill small holes
- Spindle speeds up to 50,000 RPM
- Feed with gentle finger pressure
- Free turning knurled ring with spring return upon release
- 3/4" total travel
- Standard 1/2" diameter straight shank or MT1 to go directly into the spindle of the machine

Model	Capacity (Inch)	Jacobs Mount	Diameter (Inch)	Length Closed (Inch)	Length Open (Inch)	Code
L40129B	1/64 - 5/32	JT0	0.866	1.102	1.378	827812

## Drill Chuck Arbors

### Hardened & Ground



Shank	Jacobs Taper	Code	Shank	Jacobs Taper	Code	Shank	Jacobs Taper	Code	Shank	Jacobs Taper	Code
MT1	J0	357200	1"	J2	360282	MT5	J4	360244	5/8"	J6	360266
MT2	J0	357210	ISA30	J2	363302	1/2"	J4	360254	3/4"	J6	360276
1/2"	J0	360250	ISA40	J2	363312	5/8"	J4	360264	1"	J6	360286
R8	J0	363330	ISA50	J2	363322	3/4"	J4	360274	ISA30	J6	363306
MT1	J1	357201	R8	J2	363332	1"	J4	360284	ISA40	J6	363316
MT2	J1	357211	MT1	J3	357203	ISA30	J4	363304	ISA50	J6	363326
MT3	J1	357221	MT2	J3	357213	ISA40	J4	363314	R8	J6	363336
1/2"	J1	360251	MT3	J3	357223	ISA50	J4	363324	MT1	J33	357207
5/8"	J1	360261	MT4	J3	357233	R8	J4	363334	MT2	J33	357217
ISA30	J1	363301	MT5	J3	360243	MT1	J5	357205	MT3	J33	357227
ISA40	J1	363311	1/2"	J3	360253	MT2	J5	357215	MT4	J33	357237
R8	J1	363331	5/8"	J3	360263	MT3	J5	357225	1/2"	J33	360257
MT1	J2	357202	3/4"	J3	360273	MT4	J5	357235	5/8"	J33	360267
MT2	J2	357212	1"	J3	360283	MT5	J5	360245	3/4"	J33	360277
MT3	J2	357222	ISA30	J3	363303	ISA50	J5	363325	1"	J33	360287
MT4	J2	357232	ISA40	J3	363313	R8	J5	363335	ISA30	J33	363307
MT5	J2	360242	ISA50	J3	363323	MT1	J6	357206	ISA40	J33	363317
1/2"	J2	360252	R8	J3	363333	MT2	J6	357216	ISA50	J33	363327
5/8"	J2	360262	MT1	J4	357204	MT3	J6	357226	R8	J33	363337
3/4"	J2	360272	MT2	J4	357214	MT4	J6	357236			
			MT3	J4	357224	MT5	J6	360246			
			MT4	J4	357234	1/2"	J6	360256			

## Fitted Sockets

- Hardened and ground



Size	Description	Overall Length (Inch)	Code
1 - 2	1 bore, 2 shank	6-3/16	125212
1 - 3	1 bore, 3 shank	8-15/16	125213
1 - 4	1 bore, 4 shank	7-15/18	125214
1 - 5	1 bore, 5 shank	9-3/16	125215
2 - 1	2 bore, 1 shank	6-3/8	125221
2 - 2	2 bore, 2 shank	6-13/16	125222
2 - 3	2 bore, 3 shank	7-9/16	125223
2 - 4	2 bore, 4 shank	8-9/16	125224
2 - 5	2 bore, 5 shank	9-13/16	125225
3 - 1	3 bore, 1 shank	7-1/8	125231
3 - 2	3 bore, 2 shank	7-3/4	125232
3 - 3	3 bore, 3 shank	8-1/2	125233
3 - 4	3 bore, 4 shank	9-1/2	125234
3 - 5	3 bore, 5 shank	10-3/4	125235
4 - 2	4 bore, 2 shank	8-5/8	125242
4 - 3	4 bore, 3 shank	9-7/16	125243
4 - 4	4 bore, 4 shank	10-7/16	125244
4 - 5	4 bore, 5 shank	11-11/16	125245
4 - 6	4 bore, 6 shank	14-7/16	125246
5 - 3	5 bore, 3 shank	11	125253
5 - 4	5 bore, 4 shank	11-13/16	125254
5 - 5	5 bore, 5 shank	13-1/16	125255
5 - 6	5 bore, 6 shank	16	125256
6 - 5	6 bore, 5 shank	15-3/4	125265

## Sleeves

- Hardened and ground



Size	Description	Code
1 - 2	1 bore & outside fitting 2 socket	125412
1 - 3	1 bore & outside fitting 3 socket	125413
1 - 4	1 bore & outside fitting 4 socket	125414
1 - 5	1 bore & outside fitting 5 socket	125415
2 - 3	2 bore & outside fitting 3 socket	125423
2 - 4	2 bore & outside fitting 4 socket	125424
2 - 5	2 bore & outside fitting 5 socket	125425
3 - 4	3 bore & outside fitting 4 socket	125434
3 - 5	3 bore & outside fitting 5 socket	125435
4 - 5	4 bore & outside fitting 5 socket	125445
4 - 6	4 bore & outside fitting 6 socket	125446
5 - 6	5 bore & outside fitting 6 socket	125456

## Machine Sockets



Size	Morse Taper Bore	Overall Dimensions (Inch)	Overall Length (Inch)	Code
A	MT1	1	3-1/2	125501
B	MT1	1-1/4	3-1/2	125502
C	MT1	1-1/2	3-1/2	125503
D	MT2	1	4	125504
E	MT2	1-1/4	4	125505
F	MT2	1-1/2	4	125506
G	MT2	1-3/4	4	125507
H	MT2	2	4	125508
J	MT3	1-1/4	4-3/4	125509
K	MT3	1-1/2	4-3/4	125510
L	MT3	1-3/4	4-3/4	125511
M	MT3	2	4-3/4	125512
N	MT4	1-1/2	6	125513
P	MT4	1-3/4	6	125514
Q	MT4	2	6	125515
R	MT5	2-1/4	7-3/8	125516
S	MT5	2-1/2	7-3/8	125517

## Automatic Drill Drifts



Description	Code
Suitable for MT shanks 1-3	375502
Suitable for MT shanks 4-6	375503

## Drill Drifts



Size	Description	Code
1	Fitting 1 or 2 sockets and sleeves	130101
3	Fitting 3 sockets and sleeves	130103
4	Fitting 4 sockets and sleeves	130104
5	Fitting 5 and 6 sockets and sleeves	130105



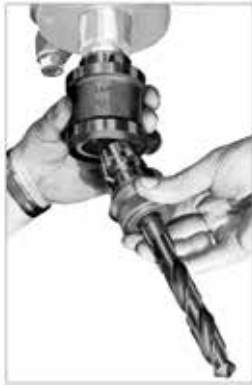

## Quick Change Tooling

### For Morse Taper Spindles

- For use on radial drills, boring mills, or any machine with Morse taper spindles
- Interchangeable with Jahr

### Master Shanks – 060201

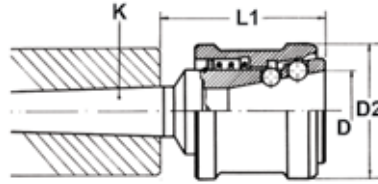

Size	D (Inch)	D (mm)	D2 (Inch)	D2 (mm)	L1 (Inch)	Shank	Part No. Reference	Code
2	1.57	40	2.63	67	3.03	MT3	0402	369400
2	1.57	40	2.63	67	3.07	MT4	0502	369401
3	2.26	57.5	3.26	83	3.74	MT4	0503	369402
4	2.70	68.7	3.97	101	4.56	MT5	0604	369403

### Morse Taper Adapters – 069901

- For tools with Morse taper and tang

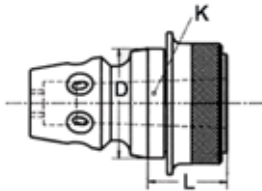

Size	Morse Taper	L (Inch)	Part No. Reference	Code
2	MT1	1.14	0202	369411
2	MT2	1.14	0203	369412
2	MT3	1.73	0204	369413
3	MT1	1.34	0302	369421
3	MT2	1.34	0303	369422
3	MT3	1.34	0304	369423
3	MT4	2.16	0305	369424
4	MT1	1.34	0402	369431
4	MT2	1.34	0403	369432
4	MT3	1.34	0404	369433
4	MT4	1.73	0405	369434
4	MT5	2.75	0406	369435

### Tapping Chucks – 069905

- To use with "BILZ" adapters

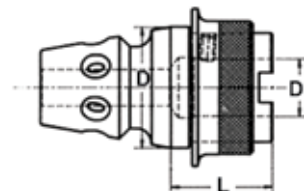

Size	BILZ No.	Capacity (Inch)	L (Inch)	Part No. Reference	Code
2	1	0 - 9/16	1.14	0202	369450
3	1	0 - 9/16	1.61	0302	369451
3	2	5/16 - 7/8	1.61	0303	369452
4	2	5/16 - 7/8	1.61	0403	369453
4	3	13/16 - 1-3/8	2.75	0404	369454

### Tapping Chucks – 06991952

- To use with "BILZ" adapters
- Tension/compression

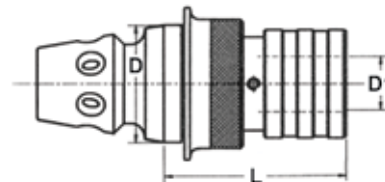

Size	BILZ No.	Capacity (Inch)	L (Inch)	Part No. Reference	Code
2	1	0 - 9/16	1.77	0222	369460
2	2	5/16 - 7/8	2.71	0223	369461
3	1	0 - 9/16	1.77	0332	369462
3	2	5/16 - 7/8	2.71	0333	369463
4	2	5/16 - 7/8	2.71	0443	369464
4	3	13/16 - 1-5/8	4.33	0444	369465

### Centering Points 60° – 069903

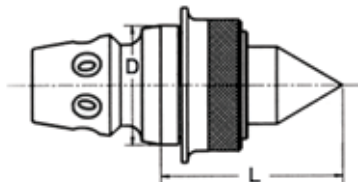

Size	L (Inch)	Part No. Reference	Code
2	2.40	0201	369417
3	2.60	0301	369427
4	2.60	0401	369437