

Standard Toe Clamps

Low & High Grip – Steel & Brass Toes

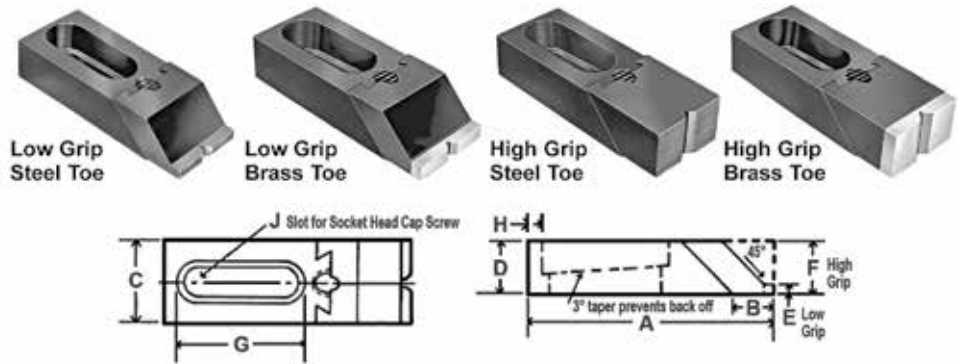

- Powerful clamps that grip on the side of the work leaving the top surface open
- Hardened for maximum wear
- Black oxide finish
- Each clamp is supplied with a protective washer
- Conforms to TCMAI/NIJFCM standards

NOTE:

- Clamps slotted for 1/2" SHCS will accept M12 SHCS and with bushing #42552, 3/8" or M10 SHCS can be used
- Clamps slotted for 5/8" SHCS will accept M16 SHCS
- Small toe clamps can be anchored with 5/16" or M8 SHCS

Low Grip Steel & Brass Toes

A (Inch)	B (Inch)	C (Inch)	D (Inch)	E (Inch)	G (Inch)	H (Inch)	J (Inch)	Low Grip Steel Toes		Low Grip Brass Toes	
								Slotted for 1/2" SHCS	Slotted for 5/8" SHCS	Slotted for 1/2" SHCS	Slotted for 5/8" SHC
								Code	Code	Code	Code
4-1/16	13/16	1-1/2	7/8	1/4	2	1/8	1/2 or 5/8	217250	217253	217256	217259
5-1/2	13/16	1-1/2	7/8	1/4	2-3/4	1/2	1/2 or 5/8	217251	217254	217257	217260
7-7/16	13/16	1-1/2	7/8	1/4	3-3/4	1	1/2 or 5/8	217252	217255	217258	217261

High Grip Steel & Brass Toes

A (Inch)	B (Inch)	C (Inch)	D (Inch)	E (Inch)	G (Inch)	H (Inch)	J (Inch)	High Grip Steel Toes		High Grip Brass Toes	
								Slotted for 1/2" SHCS	Slotted for 5/8" SHCS	Slotted for 1/2" SHCS	Slotted for 5/8" SHC
								Code	Code	Code	Code
4-1/16	13/16	1-1/2	7/8	1/4	2	1/8	1/2 or 5/8	217262	217265	217268	217271
5-1/2	13/16	1-1/2	7/8	1/4	2-3/4	1/2	1/2 or 5/8	217263	217266	217269	217272
7-7/16	13/16	1-1/2	7/8	1/4	3-3/4	1	1/2 or 5/8	217264	217267	217270	217273

Machinist's Clamp Sets

Inch & Metric

Inch Set

Set includes:

- 4 coupling nuts
- 4 flanged nuts
- 6 T-slot nuts
- 1 T-slot cleaner
- 24 studs with flats – 4 each of 3", 4", 5", 6", 7" and 8" long
- 6 stepped blocks
- 6 serrated end clamps

Packed in carton - metal storage container not included

Table Slot (Inch)	Stud Size	Weight (lbs)	Code
7/16	3/8 - 16	19	217330
1/2	3/8 - 16	19	217331
9/16	3/8 - 16	19	217332
9/16	1/2 - 13	24	217333
11/16	1/2 - 13	24	217334
5/8	1/2 - 13	24	217335
11/16	5/8 - 11	29	217336
3/4	5/8 - 11	29	217337
13/16	5/8 - 11	29	217338

Metric Set

- Standard 1" wide blocks

Table Slot (mm)	Stud Size	Net Weight (lbs)	Code
12	M10	19	217569
14	M12	24	217570

Table Slot (mm)	Stud Size	Net Weight (lbs)	Code
16	M12	24	217571
18	M16	31	217572
20	M16	31	217573

Clamping Sets

Wall Mount

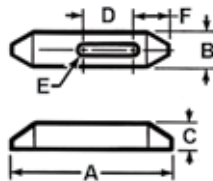

Table Slot (Inch)	Stud Size	Block Width (Inch)	Model	Code
1/2	3/8-16	1	500CKM	400010
5/8	1/2-13	1	625CKM	400020
3/4	5/8-11	1	750CKM	400030

Plain Clamps



- Black oxide finish
- Case hardened



A (Inch)	B (Inch)	C (Inch)	D (Inch)	E Stud Size (Inch)	F (Inch)	Code
2-1/2	1	1/2	13/16	5/16 or 3/8	27/32	217358
4	1	5/8	1-7/16	5/16 or 3/8	1-1/32	217359
6	1-1/8	3/4	2-3/16	5/16 or 3/8	1-5/32	217360
2-1/2	1-1/8	1/2	11/16	1/2	29/32	217361
4	1-1/4	3/4	1-5/16	1/2	1-5/32	217362
6	1-1/4	7/8	2-1/16	1/2	1-9/32	217363
2-1/2	1-1/4	5/8	9/16	5/8	31-32	217364
4	1-1/2	3/4	1-3/16	5/8	1-9/32	217365
6	1-1/2	7/8	1-15/16	5/8	1-13/32	217366
4	1-1/2	3/4	1-1/16	3/4	1-11/32	217367
6	1-1/2	1	1-15/16	3/4	1-15/32	217368
8	1-3/4	1-1/8	2-3/16	3/4	1-29/32	217369
6	2	1-1/4	1-11/16	7/8 or 1	1-27/32	217370
8	2	1-3/8	1-15/16	7/8 or 1	2-1/32	217371
10	2	1-1/2	2-15/16	7/8 or 1	2-1/32	217372

Plain Clamps



Bolt Size (Inch)	Length (Inch)	Width (Inch)	Thickness (Inch)	Code	Bolt Size (Inch)	Length (Inch)	Width (Inch)	Thickness (Inch)	Code
3/8	2-1/2	1	1/2	400302	5/8	6	1-1/2	7/8	400326
3/8	4	1	5/8	400304	3/4	4	1-1/2	3/4	400334
3/8	6	1-1/8	3/4	400306	3/4	6	1-1/2	1	400336
1/2	2-1/2	1-1/8	1/2	400312	3/4	8	1-3/4	1-1/8	400338
1/2	4	1-1/4	3/4	400314	1	6	2	1-1/4	400346
1/2	6	1-1/4	7/8	400316	1	8	2	1-3/8	400348
5/8	2-1/2	1-1/4	5/8	400322	1	10	2	1-1/2	400350
5/8	4	1-1/2	3/4	400324					

Flanged Nuts

Northwestern

Inch & Metric

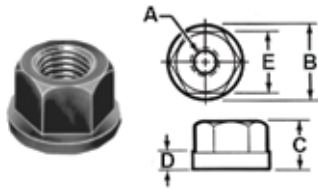

- UNC
- Heat treated steel with black oxide finish for long life under repeated usage
- Flange provides large bearing surface and reduces chance of possible damage to part being clamped

Inch

A Thread Size	B (Inch)	C (Inch)	D (Inch)	E (Inch)	Code
1/4-20	5/8	5/16	3/32	1/2	217339
5/16-18	3/4	3/8	1/8	9/16	217340
3/8-16	7/8	1/2	1/8	11/16	217341
7/16-14	1	9/16	5/32	3/4	217342
1/2-13	1-1/8	11/16	3/16	7/8	217343
5/8-11	1-3/8	13/16	3/16	1-1/16	217344
3/4-10	1-5/8	1	1/4	1-1/4	217345
7/8-9	1-3/4	1-1/8	1/4	1-7/16	217346
1-8	2	1-1/4	1/4	1-5/8	217347
1-1/4-7	2-1/2	1-1/4	1/4	1-13/16	217348

Metric

A Thread Size	B (mm)	C (mm)	D (mm)	E (mm)	Code
M8 x 1.25	19.0	9.5	2.4	14.3	217607
M10 x 1.50	22.2	12.7	3.2	17.4	217608
M12 x 1.75	28.5	17.4	4.0	22.2	217609
M16 x 2.00	35.0	20.6	4.7	27.0	217610

Flanged Nuts

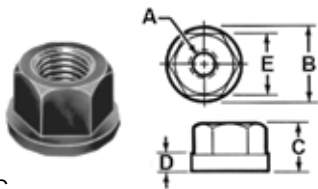

- UNC
- Heat treated steel with black oxide finish for long life under repeated usage

A Thread Size	B (Inch)	C (Inch)	D (Inch)	E (Inch)	Code
5/16 - 18	3/4	3/8	3/32	9/16	400800
3/8 - 16	7/8	1/2	1/8	11/16	400802
1/2 - 13	1-5/16	11/16	1/8	13/16	400804
5/8 - 11	1-3/8	13/16	3/16	1-1/16	400806
3/4 - 10	1-1/2	1	1/4	1-1/4	400808
7/8 - 9	1-3/4	1-1/8	1/4	1-7/16	400810
1 - 8	2	1-1/4	1/4	1-5/8	400812

Coupling Nuts

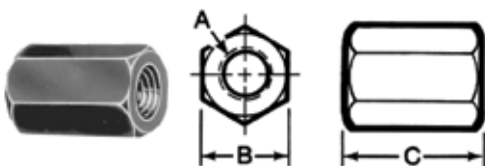

- Heat treated steel with black oxide finish

A Thread Size	B Hex Size (Inch)	C Length (Inch)	Code
5/16 - 18	9/16	7/8	400601
3/8 - 16	11/16	1	400602
1/2 - 13	7/8	1-1/4	400604
5/8 - 11	1-1/16	1-5/8	400606
3/4 - 10	1-1/4	1-7/8	400608
7/8 - 9	1-7/16	2-1/4	400610
1 - 8	1-5/8	2-1/2	400612

Coupling Nuts

Inch & Metric

Northwestern

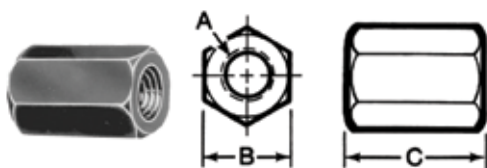

- Heat treated steel with black oxide finish for long life under repeated usage
- Coupling nut allows studs to be joined together to create desired length

Inch

A Thread Size	B (Inch)	C (Inch)	Code
1/4 - 20	1/2	5/8	217349
5/16 - 18	9/16	7/8	217350
3/8 - 16	11/16	1	217351
7/16 - 14	3/4	1-1/4	217352
1/2 - 13	7/8	1-1/4	217353
5/8 - 11	1-1/16	1-5/8	217354
3/4 - 10	1-1/4	1-7/8	217355
7/8 - 9	1-7/16	2-1/4	217356
1 - 8	1-5/8	2-1/2	217357

Metric

A Thread Size	B (mm)	C (Inch)	Code
M8 x 1.25	14.3	22	217611
M10 x 1.50	17.4	25	217612
M12 x 1.75	22.2	32	217613
M16 x 2.00	27.0	41	217614

T-Slot Nuts

Inch & Metric

Northwestern

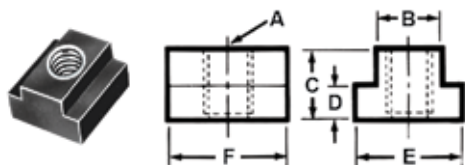

- Black oxide finish
- Case hardened
- Many sizes conform to TCMA standards
- The last thread is incomplete on T-Slot nuts to prevent the stud from turning through bottom of nut into machine table

To keep from damaging the T-Nut, the mating thread must be threaded as far as possible into the T-Slot Nuts. Standard T-Slot Nuts have an incomplete thread in the base to eliminate any danger of screwing the stud through the nut and damaging the machine table.

Inch

B Table Slot (Inch)	A Thread Size	E (Inch)	D (Inch)	C (Inch)	F Length (Inch)	Code
3/8	5/16 - 18	5/8	3/16	1/2	7/8	217373
7/16	3/8 - 16	11/16	7/32	1/2	7/8	217374
1/2	3/8 - 16	7/8	9/32	1/2	7/8	217375
9/16	3/8 - 16	7/8	11/32	5/8	1-1/8	217376
9/16	1/2 - 13	7/8	11/32	5/8	1-1/8	217377
5/8	1/2 - 13	1	11/32	5/8	1-1/8	217378
11/16	1/2 - 13	1-1/8	7/16	3/4	1-1/4	217379
11/16	5/8 - 11	1-1/8	7/16	3/4	1-1/4	217380
3/4	5/8 - 11	1-1/4	15/32	3/4	1-1/4	217381
13/16	5/8 - 11	1-1/4	9/16	1	1-1/2	217382
13/16	3/4 - 10	1-1/4	9/16	1	1-1/2	217383
7/8	3/4 - 10	1-1/2	9/16	1	1-1/2	217384
1	3/4 - 10	1-5/8	5/8	1	1-3/4	217385
1	7/8 - 9	1-5/8	5/8	1	1-3/4	217387
1-1/16	3/4 - 10	1-5/8	11/16	1-1/8	2	217386
1-1/16	1 - 8	1-5/8	11/16	1-1/8	2	217388

Metric

B Table Slot (mm)	A Thread Size	E (mm)	D (mm)	C (mm)	F Length (mm)	Code
10	M8 x 1.25	16.0	6	12.7	22	217601
12	M10 x 1.50	22.0	7	12.7	22	217602
14	M12 x 1.75	22.0	8	16.0	29	217603
16	M12 x 1.75	25.4	9	16.0	29	217604
18	M16 x 2.00	31.7	11	19.0	32	217605
20	M16 x 2.00	31.7	12	25.4	38	217606

T-Slot Nuts

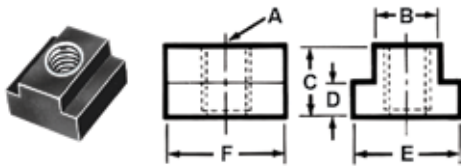

- Black oxide finish
- Case hardened
- Many sizes conform to TCMA standards
- The last thread is incomplete on T-Slot nuts to prevent the stud from turning through bottom of nut into machine table

B Table Slot (Inch)	A Thread Size	E (Inch)	D (Inch)	C (Inch)	F Length (Inch)	Code
3/8	5/16 – 18	5/8	3/16	1/2	7/8	400701
7/16	3/8 – 16	11/16	7/32	1/2	7/8	400702
1/2	3/8 – 16	7/8	9/32	1/2	7/8	400704
9/16	3/8 – 16	7/8	11/32	5/8	1-1/8	400706
9/16	1/2 – 13	7/8	11/32	5/8	1-1/8	400708
5/8	1/2 – 13	1	11/32	5/8	1-1/8	400710
11/16	1/2 – 13	1-1/8	7/16	3/4	1-1/4	400712
11/16	5/8 – 11	1-1/8	7/16	3/4	1-1/4	400714
3/4	5/8 – 11	1-1/4	15/32	3/4	1-1/4	400716
13/16	5/8 – 11	1-1/4	9/16	1	1-1/2	400718
13/16	3/4 – 10	1-1/4	9/16	1	1-1/2	400720
7/8	3/4 – 10	1-1/2	9/16	1	1-1/2	400722
1	3/4 – 10	1-5/8	5/8	1	1-3/4	400724
1-1/16	3/4 – 10	1-5/8	11/16	1-1/8	2	400726
1	7/8 – 9	1-5/8	5/8	1	1-3/4	400728
1-1/16	1 – 8	1-5/8	11/16	1-1/8	2	400730

T-Slot Cleaner



- Heat treated steel
- Black oxide finish
- Eliminates the danger of removing chips with air
- Saves time

Northwestern

Length (Inch)	Code
6	217389

T-Slot Bolts

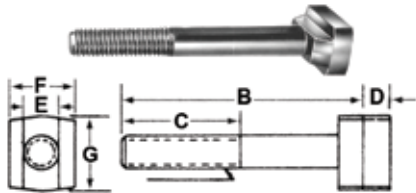

- Black oxide finish
- Medium carbon steel
- Diameters offered include 3/8", 1/2", 5/8", 3/4", 7/8" and 1"
- T-Slot bolt head thickness "D" is undersized to fit machine table slot
- Thread class 2A UNC
- Sizes functionally interchange with forged T-Slot bolts

Northwestern

3/8-16

B Length (Inch)	C (Inch)	D (Inch)	E (Inch)	F (Inch)	G (Inch)	Code	B Length (Inch)	C (Inch)	D (Inch)	E (Inch)	F (Inch)	G (Inch)	Code
1-1/2	1	13/64	3/8	5/8	3/4	217390	3-1/2	1-1/2	13/64	3/8	5/8	3/4	217394
2	1-1/4	13/64	3/8	5/8	3/4	217391	4	1-1/2	13/64	3/8	5/8	3/4	217395
2-1/2	1-1/2	13/64	3/8	5/8	3/4	217392							
3	1-1/2	13/64	3/8	5/8	3/4	217393							

5/8-11

B Length (Inch)	C (Inch)	D (Inch)	E (Inch)	F (Inch)	G (Inch)	Code	B Length (Inch)	C (Inch)	D (Inch)	E (Inch)	F (Inch)	G (Inch)	Code
1-1/2	1	5/16	5/8	1-1/64	1-1/8	217404	3-1/2	1-1/2	5/16	5/8	1-1/64	1-1/8	217408
2	1-1/4	5/16	5/8	1-1/64	1-1/8	217405	4	1-1/2	5/16	5/8	1-1/64	1-1/8	217409
2-1/2	1-1/2	5/16	5/8	1-1/64	1-1/8	217406	5	1-1/2	5/16	5/8	1-1/64	1-1/8	217410
3	1-1/2	5/16	5/8	1-1/64	1-1/8	217407	6	2	5/16	5/8	1-1/64	1-1/8	217411
							8	3	5/16	5/8	1-1/64	1-1/8	217412

T-Slot Bolts

(continued)

3/4-10

B Length (Inch)	C (Inch)	D (Inch)	E (Inch)	F (Inch)	G (Inch)	Code	B Length (Inch)	C (Inch)	D (Inch)	E (Inch)	F (Inch)	G (Inch)	Code
3	1-1/2	3/8	3/4	1-1/4	1-3/8	217413	6	2	3/8	3/4	1-1/4	1-3/8	217417
3-1/2	1-1/2	3/8	3/4	1-1/4	1-3/8	217414	8	3	3/8	3/4	1-1/4	1-3/8	217418
4	1-1/2	3/8	3/4	1-1/4	1-3/8	217415							
5	1-1/2	3/8	3/4	1-1/4	1-3/8	217416							

1-8

B Length (Inch)	C (Inch)	D (Inch)	E (Inch)	F (Inch)	G (Inch)	Code	B Length (Inch)	C (Inch)	D (Inch)	E (Inch)	F (Inch)	G (Inch)	Code
4	2	1/2	1	1-21/32	1-7/8	217419	6	2	1/2	1	1-21/32	1-7/8	217421
5	2	1/2	1	1-21/32	1-7/8	217420	8	3	1/2	1	1-21/32	1-7/8	217422
							10	3	1/2	1	1-21/32	1-7/8	217423

1/2-13

B Length (Inch)	C (Inch)	D (Inch)	E (Inch)	F (Inch)	G (Inch)	Code	B Length (Inch)	C (Inch)	D (Inch)	E (Inch)	F (Inch)	G (Inch)	Code
1-1/2	1	1/4	1/2	13/16	1	217396	3-1/2	1-1/2	1/4	1/2	13/16	1	217400
2	1-1/4	1/4	1/2	13/16	1	217397	4	1-1/2	1/4	1/2	13/16	1	217401
2-1/2	1-1/2	1/4	1/2	13/16	1	217398	5	1-1/2	1/4	1/2	13/16	1	217402
3	1-1/2	1/4	1/2	13/16	1	217399	6	2	1/4	1/2	13/16	1	217403

Serrated Step Clamps

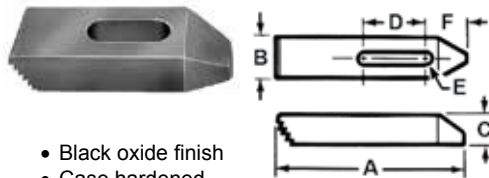

- Black oxide finish
- Case hardened
- Teeth match all stepped blocks

A (Inch)	B (Inch)	C (Inch)	D (Inch)	E Stud Size (Inch)	F (Inch)	Code
2-1/2	1	1/2	13/16	5/16 or 3/8	27/32	217424
4	1	5/8	1-7/16	5/16 or 3/8	1-1/32	217425
6	1-1/8	3/4	2-3/16	5/16 or 3/8	1-5/32	217426
2-1/2	1-1/8	1/2	11/16	1/2	29/32	217427
4	1-1/4	3/4	1-5/16	1/2	1-5/32	217428
6	1-1/4	7/8	2-1/16	1/2	1-9/32	217429
2-1/2	1-1/4	5/8	9/16	5/8	31/32	217430
4	1-1/2	3/4	1-3/16	5/8	1-9/32	217431
6	1-1/2	7/8	1-15/16	5/8	1-13/32	217432
4	1-1/2	3/4	1-1/16	3/4	1-11/32	217433
6	1-1/2	1	1-15/16	3/4	1-15/32	217434
8	1-3/4	1-1/8	2-3/16	3/4	1-29/32	217435
6	2	1-1/4	1-11/16	7/8 or 1	1-27/32	217436
8	2	1-3/8	1-15/16	7/8 or 1	2-1/32	217437
10	2	1-1/2	2-15/16	7/8 or 1	2-1/32	217438

Serrated Step Clamps



Thickness (Inch)	Length (Inch)	Width (Inch)	Bolt Size (Inch)	Code
1/2	2-1/2	1	3/8	400202
5/8	4	1	3/8	400204
3/4	6	1-1/8	3/8	400206
1/2	2-1/2	1-1/8	1/2	400212
3/4	4	1-1/4	1/2	400214
7/8	6	1-1/4	1/2	400216
5/8	2-1/2	1-1/4	5/8	400222
3/4	4	1-1/2	5/8	400224
7/8	6	1-1/2	5/8	400226
3/4	4	1-1/2	3/4	400234
1	6	1-1/2	3/4	400236
1-1/8	8	1-3/4	3/4	400238
1-1/4	6	2	1	400246
1-3/8	8	2	1	400248
1-1/2	10	2	1	400250

Stepped Blocks

Northwestern

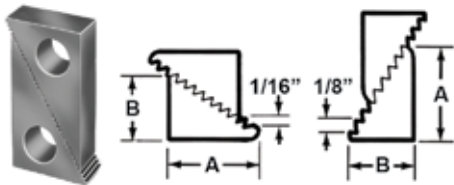

- Chamfered holes in larger sizes for ease of use
- Steel stepped blocks have black oxide finish
- Two halves = one block – order by block
- Teeth match serrated stepped clamps

Width (Inch)	Height Adjustment Range (Inch)	A (Inch)	B (Inch)	Code
1	3/4 – 1-5/8	1-1/16	11/16	217439
1	1-1/8 – 2-1/2	1-39/64	1-1/16	217440
1	2-1/2 – 6	3-3/4	2-15/32	217441
1-1/2	1-3/4 – 4	2-17/32	1-43/64	217442
1-1/2	2-1/2 – 6	3-3/4	2-15/32	217443
1-1/2	3-1/2 – 9	5-21/64	3-7/16	217444
2	1-3/4 – 4	2-17/32	1-43/64	217445
2	2-1/2 – 6	3-3/4	2-15/32	217446
2	3-1/2 – 9	5-21/64	3-7/16	217447

Stepped Blocks



Height Adjustability (Inch)	Stud Width (Inch)	Code
3/4 – 1-1/2	1	400101
1-1/8 – 2-1/2	1	400102
2-1/2 – 6	1	400103
1-1/2 – 3-3/4	1-1/2	400114
2-1/2 – 6	1-1/2	400115
3-1/2 – 9	1-1/2	400116
1-1/2 – 3-3/4	2	400127
2-1/2 – 6	2	400128
3-1/2 – 9	2	400129

T-Nut & Stud Sets



Table Slot (Inch)	Stud Size	Code
5/8	1/2 - 13	400055
3/4	5/8 - 11	400060
7/8	3/4 - 10	400065

Step Block & Clamps

12-Piece Sets



Block Width (Inch)	Stud Size (Inch)	Code
1	3/8	400075
1	1/2	400080

Clamping Studs

Inch & Metric – Material TO ASTM A 311 Class B

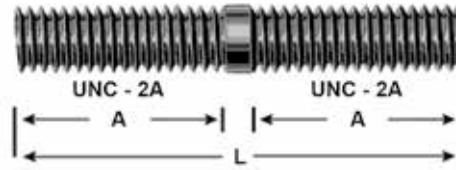

Inch

L Length (Inch)	1/4–20		5/16–18		3/8–16		1/2–13		5/8–11		3/4–10		7/8–9		1–8	
	A (Inch)	Code	A (Inch)	Code	A (Inch)	Code	A (Inch)	Code	A (Inch)	Code	A (Inch)	Code	A (Inch)	Code	A (Inch)	Code
1-1/2	1	217448	1-1/8	217454	1-1/4	217465	1-1/2	217479	1-3/4	217497	–	–	–	–	–	–
2	1	217449	1-1/8	217455	1-1/4	217466	1-1/2	217480	1-3/4	217498	–	–	–	–	–	–
2-1/2	1	217450	1-1/8	217456	1-1/4	217467	1-1/2	217481	1-3/4	217499	–	–	–	–	–	–
3	1	217451	1-1/8	217457	1-1/4	217468	1-1/2	217482	1-3/4	217500	2	217515	2-1/4	217533	2-1/2	217546
3-1/2	1	217452	1-1/8	217458	1-1/4	217469	1-1/2	217483	1-3/4	217501	2	217516	–	–	–	–
4	1	217453	1-1/8	217459	1-1/4	217470	1-1/2	217484	1-3/4	217502	2	217517	2-1/4	217534	2-1/2	217547
4-1/2	–	–	1-1/8	217460	1-1/4	217471	1-1/2	217485	1-3/4	217503	2	217518	–	–	–	–
5	–	–	1-1/8	217461	1-1/4	217472	1-1/2	217486	1-3/4	217504	2	217519	2-1/4	217535	2-1/2	217548
5-1/2	–	–	–	–	1-1/4	217473	1-1/2	217487	1-3/4	217505	2	217520	–	–	–	–
6	–	–	1-1/8	217462	1-1/4	217474	1-1/2	217488	1-3/4	217506	2	217521	2-1/4	217536	2-1/2	217549
6-1/2	–	–	–	–	1-1/4	217475	1-1/2	217489	1-3/4	217507	2	217522	–	–	–	–
7	–	–	1-1/8	217463	1-1/4	217476	1-1/2	217490	1-3/4	217508	2	217523	2-1/4	217537	2-1/2	217550
7-1/2	–	–	–	–	1-1/4	217477	1-1/2	217491	1-3/4	217509	2	217524	–	–	–	–
8	–	–	1-1/8	217464	1-1/4	217478	1-1/2	217492	1-3/4	217510	2	217525	2-1/4	217538	2-1/2	217551
9	–	–	–	–	–	–	2	217493	2	217511	2	217526	2-1/4	217539	2-1/2	217552
10	–	–	–	–	–	–	2	217494	2	217512	2	217527	2-1/4	217540	2-1/2	217553
12	–	–	–	–	–	–	2	217495	2	217513	2	217528	2-1/4	217541	2-1/2	217554
14	–	–	–	–	–	–	2	217496	2	217514	2	217529	2-1/4	217542	2-1/2	217555
16	–	–	–	–	–	–	–	–	–	–	2	217530	2-1/4	217543	2-1/2	217556
18	–	–	–	–	–	–	–	–	–	–	2	217531	2-1/4	217544	2-1/2	217557
20	–	–	–	–	–	–	–	–	–	–	2	217532	2-1/4	217545	2-1/2	217558

Metric

L Length (mm)	M8 x 1.25		M10 x 1.5		M12 x 1.75		M16 x 2.0	
	A (mm)	Code	A (mm)	Code	A (mm)	Code	A (mm)	Code
50	33	217577	–	–	–	–	–	–
65	33	217578	35	217583	–	–	–	–
80	33	217579	35	217584	39	217589	47	217595
95	33	217580	35	217585	39	217590	–	–
110	33	217581	35	217586	39	217591	47	217596
125	33	217582	35	217587	39	217592	47	217597
150	–	–	35	217588	39	217593	47	217598
175	–	–	–	–	39	217594	47	217599
200	–	–	–	–	–	–	47	217600

Clamping Studs

Inch



L Length (Inch)	5/16-18		3/8-16		1/2-13		5/8-11		3/4-10		7/8-9		1-8	
	A (Inch)	Code	A (Inch)	Code	A (Inch)	Code	A (Inch)	Code	A (Inch)	Code	A (Inch)	Code	A (Inch)	Code
3	3/4	400393	1-1/4	400403	1-1/2	400423	1-3/4	400443	2	400463	2-1/4	400482	2-1/2	400501
4	3/4	400394	1-1/4	400405	1-1/2	400425	1-3/4	400445	2	400465	2-1/4	400484	2-1/2	400503
5	3/4	400395	1-1/4	400407	1-1/2	400427	1-3/4	400447	2	400467	2-1/4	400486	2-1/2	400505
6	3/4	400396	1-1/4	400409	1-1/2	400429	1-3/4	400449	2	400469	2-1/4	400488	2-1/2	400507
7	3/4	400397	1-1/4	400411	1-1/2	400431	1-3/4	400451	2	400471	2-1/4	400490	2-1/2	400509
8	3/4	400398	1-1/4	400413	1-1/2	400433	1-3/4	400453	2	400473	2-1/4	400492	2-1/2	400511
10	-	-	-	-	-	-	1-3/4	400455	2	400475	2-1/4	400494	2-1/2	400513
12	-	-	-	-	-	-	1-3/4	400457	2	400476	2-1/4	400495	2-1/2	400514
14	-	-	-	-	-	-	-	-	2	400477	2-1/4	400496	2-1/2	400515
16	-	-	-	-	-	-	-	-	2	400478	2-1/4	400497	2-1/2	400516
18	-	-	-	-	-	-	-	-	2	400479	2-1/4	400498	2-1/2	400517
20	-	-	-	-	-	-	-	-	2	400480	2-1/4	400499	2-1/2	400518

Screw Jacks & Pads



No. 6400



- For clamping and setting
- Screw jack flat top with center hole 12mm diameter
- Acme thread, self-locking, spindle with end stops
- Material: carbon steel

No. 6401



- For clamping and setting
- Screw jack with aluminum base
- Locating hole: 12mm diameter
- Spindle: superior quality steel brown finish treated trapeze thread with end stop

Size (mm)	Hi-Low (mm)	Top Diameter (mm)	Base Diameter (mm)	Load (kN)	Code
50	40-50	32	32	15	405902
52	42-52	50	50	60	405904
70	50-70	50	50	60	405906
100	70-100	50	50	60	405908
140	100-140	65	70-2	100	405910
210	140-210	70	80-2	170	405912
300	190-300	80	100-2	350	405914
200	140-200	80	100-2	350	405916
280	190-280	110	140-2	600	405918

Size (mm)	Hi-Low (mm)	Top Diameter (mm)	Base Diameter (mm)	Load (kN)	Code
52	42-52	50	50	30	405920
70	50-70	50	50	30	405922
100	70-100	50	50	30	405924

No. 6430



- For clamping and setting
- Atlas screw jack center hole 12mm diameter
- Spindle: Acme thread TR 30 x 6
- Material: carbon steel

Size (mm)	Hi-Low (mm)	Top Diameter (mm)	Base Diameter (mm)	Load (kN)	Code
140	100-140	50	50	60	405926
200	140-200	50	50	60	405928
320	200-320	50	50	40	405930
550	320-550	50	50	25	405932

Screw Jack Pads



Pad No.	For Clamping and Setting Screw Jacks		
	6400	6401	6430
6440	•	•	•
6441	•	•	•
6442	•	•	•
6443	•	—	•

Pad No.	Code
6440	405940
6441	405942
6442	405944
6443	405948

Hi-Rise Clamps & Accessories



Standard Hi-Rise Clamps – 34-Piece Sets



- A 1/4 turn of the clamp disengages the tangs from the slots in the rack allowing the clamp to move up and down
- Adding extensions to the rack gives an unlimited clamping range
- Racks and clamps are hardened to provide better wear resistance

Sets include:

- 2 Studs of each length: 3", 4", 5", 6", 7" and 8"
- 2 Extensions, 4" long
- 2 Extensions, 6-1/2" long
- 2 T-Slot Nuts to fit your machine
- 2 Aluminum Bases
- 2 Toggle Flanged Nuts
- 2 Clamp Supports
- 4 Coupling Nuts
- 1 "T" Slot Cleaner
- 2 Standard length Hi-Rise Clamps
- 1 Handy Holder
- 2 Slotted Racks 6" long

Stud Size	Table Slot (Inch)	Net Weight per Set (lbs)	Code
3/8 - 16	7/16	16	217615
3/8 - 16	1/2	16	217616
3/8 - 16	9/16	16	217617
1/2 - 13	9/16	18	217618
1/2 - 13	5/8	18	217619
1/2 - 13	11/16	18	217620
5/8 - 11	11/16	20	217621

Stud Size	Table Slot (Inch)	Net Weight per Set (lbs)	Code
5/8 - 11	3/4	20	217622
5/8 - 11	13/16	21	217623
3/4 - 10	13/16	24	217624
3/4 - 10	7/8	24	217625
3/4 - 10	1	24	217626
3/4 - 10	1-1/16	25	217627

Hi-Rise Clamps

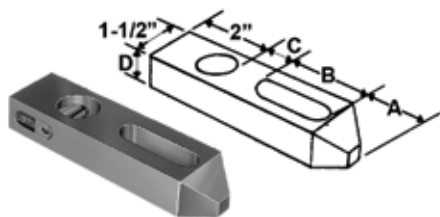

- Heat treated alloy steel
- Black oxide finish
- Clamp slides up or down the slotted rack for fast height adjustment

Style	Stud Size (Inch)	A (Inch)	B (Inch)	C (Inch)	D (Inch)	Code
Standard	3/8	3/4	2	3/4	7/8	217641
Long Reach	3/8	1-1/8	3	1-3/8	7/8	217642
Standard	1/2	3/4	2	3/4	7/8	217643
Long Reach	1/2	1-1/8	3	1-3/8	7/8	217644
Standard	5/8	3/4	2	3/4	7/8	217645
Long Reach	5/8	1-1/8	3-1/2	1-7/8	1-1/8	217646
Standard	3/4	3/4	2	3/4	7/8	217647
Long Reach	3/4	1-1/8	3-1/2	1-7/8	1-1/8	217648

Solid Extensions



- Extends the slotted rack for larger height requirements
- Black oxide finish

Length (Inch)	Diameter (Inch)	Code
4	1	217649
6-1/2	1	217650

Aluminum Base



- Provides solid support
- Protects tables

Height (Inch)	Diameter (Inch)	Code
5/8	2-1/2	217651

Slotted Rack



- Slots let clamps adjust within 1/16" of work height
- Heat treated alloy steel
- Black oxide finish

Length (Inch)	Diameter (Inch)	Code
6	1	217652

Toggle Clamps & Accessories

Vertical Handle Toggle Clamp

- Miniature size
- Holding capacity: 50 kg (100 lbs) maximum
- Weight: 60 g (2 oz)
- Handle moves 56°, bar 100°
- Neoprene tipped
- Vinyl hand grip

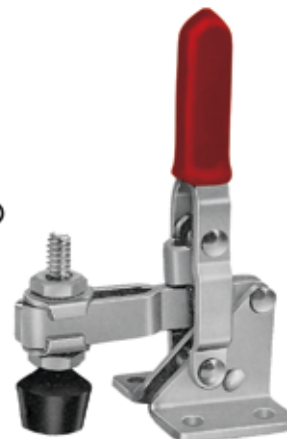
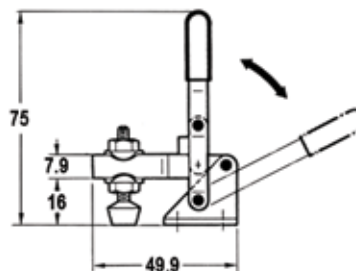
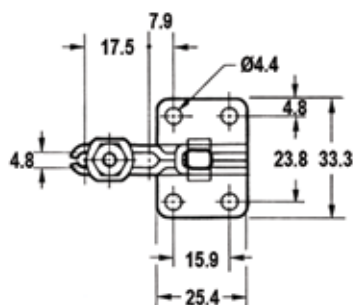

Model	Description	Code
SH-101-A	U-bar, flanged base, straight handle	412101

Vertical Handle Toggle Clamps

- Holding capacity: 91 kg (200 lbs) maximum
- Weight: 170 g (6 oz)
- Handle moves 60°, bar 100°
- Neoprene tipped
- Solid bar
- Vinyl hand grip

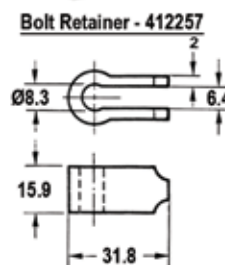
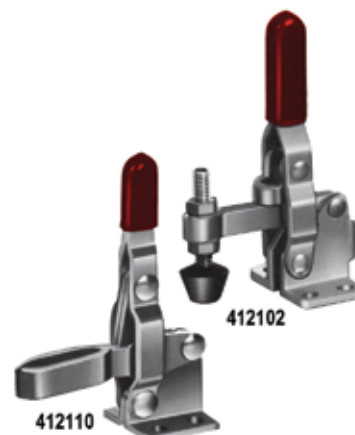
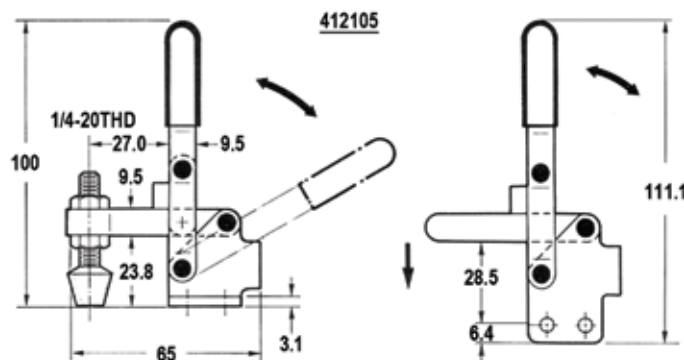
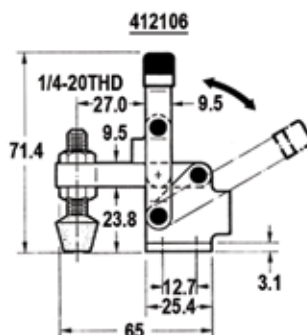
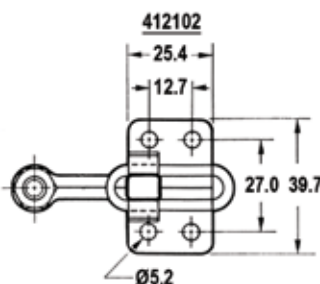

Model	Description	Code
SH-12050	Fixed spindle, flanged base, straight handle	412102
SH-12055	Fixed spindle, straight base, straight handle	412103
SH-12060	Solid bar, flanged base, straight handle	412104
SH-12065	Solid bar, straight base, straight handle	412105
SH-12070	Fixed spindle, flanged base, T-handle	412106
SH-12075	Fixed spindle, straight base, T-handle	412107
SH-12080	Solid bar, flanged base, T-handle	412108
SH-12050-U	U-bar, flanged base, straight handle	412110

Toggle Clamps & Accessories

(continued)

Vertical Handle Toggle Clamps

- Holding capacity: 340 kg (750 lbs) maximum
- Weight: 624 g (1 lb, 6 oz)
- Handle moves 58°, bar 105°
- Accepts all 3/8-16 diameter spindles
- U-Bar supplied with two flanged washers
- Solid bar supplied (spindle not included)
- Vinyl hand grip

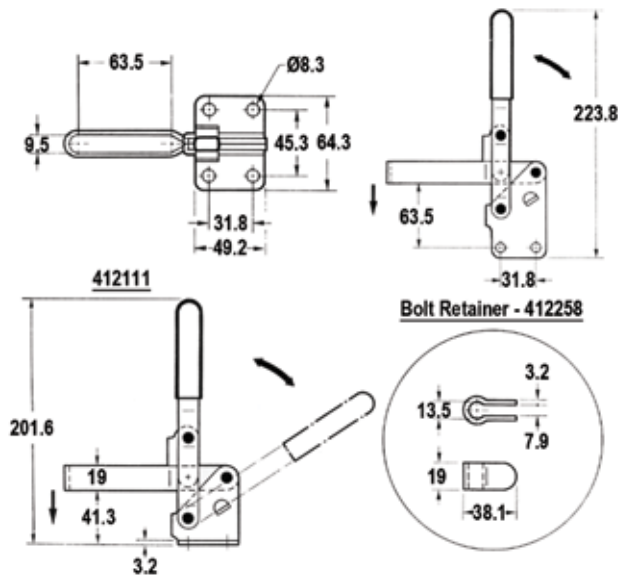

Model	Description	Code
12265	U-bar, flanged base, straight handle	412111
12275	Solid bar, flanged base, straight handle	412113
12280	Solid bar, straight base, straight handle	412114

Vertical Handle Toggle Clamps

- Heavy duty
- Compact size
- Two stops provide user with a choice of handle and bar movement
- Holding capacity: 450 kg (1000 lbs) maximum
- Weight: 1250 g (44 oz)
- Handle moves 58°, bar 100° (with roll pin)
- Handle moves 70°, bar 135° (without roll pin)
- Accepts all 1/2 - 13 diameter spindles
- U-Bar supplied with two flanged washers
- Solid bar (spindle not included)
- Vinyl hand grip
- Hardened bushings
- Removable ground pins

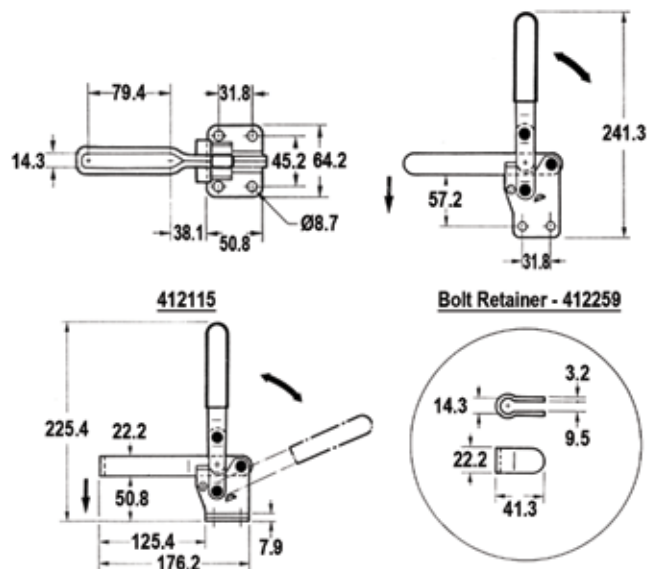

Model	Description	Code
10247	U-bar, flanged base, straight handle	412115
10249	Solid bar, flanged base, straight handle	412117
10250	Solid bar, straight base, straight handle	412118

Toggle Clamps & Accessories

(continued)

Vertical Handle Toggle Clamps

- Holding capacity: 227 kg (500 lbs) maximum
- Handle moves 60°, bar 100°
- Accepts all 5/16-18 diameter spindles
- U-Bar supplied with two flanged washers
- Vinyl hand grip

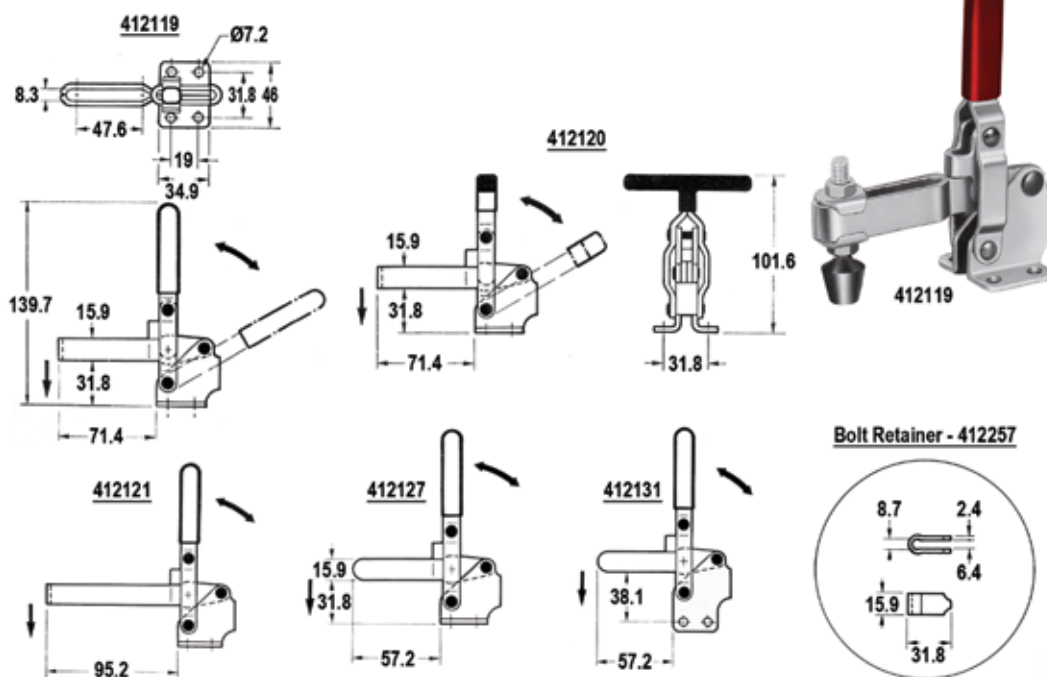

Model	Description	Weight g (oz)	Code
12130	Short U-bar, flanged base, straight handle	355 (12.5)	412119
12131	Short U-bar, flanged base, T-handle	370 (13)	412120
12132	Long U-bar, flanged base, straight handle	370 (13)	412121
12137	Long U-bar, straight base, straight handle	370 (13)	412125
12138	Long U-bar, straight base, T-handle	400 (12.5)	412126
12140	Short solid bar, flanged base, straight handle	340 (12)	412127
12143	Long solid bar, flanged base, T-handle	375 (13)	412130
12145	Short solid bar, straight base, straight handle	340 (12)	412131

Vertical Handle Toggle Clamp with Vertical Mount

- Holding capacity: 90 kg (200 lbs)
- Weight: 115 g (4 oz)
- U-bar
- Vertical mounting straight base
- Vertical handle
- Neoprene tipped
- Vinyl hand grip

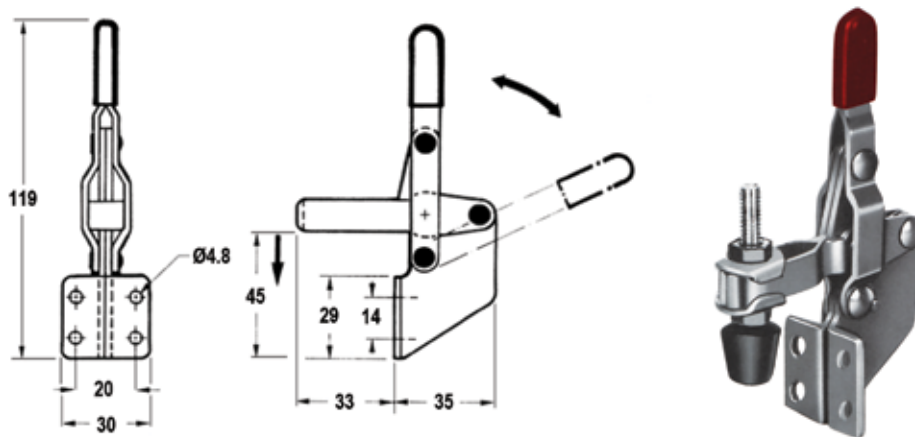

Model	Description	Code
101B	U-bar, vertical mount, straight handle	412175

CLAMPING COMPONENTS

Toggle Clamps & Accessories

(continued)

Horizontal Handle Toggle Clamps with Vertical Mount

- Holding capacity: 217 kg (480 lbs)
- Weight: 315 g (11 oz)
- U-bar
- Straight base, vertical mounting
- Horizontal handle
- Neoprene tipped
- Vinyl hand grip

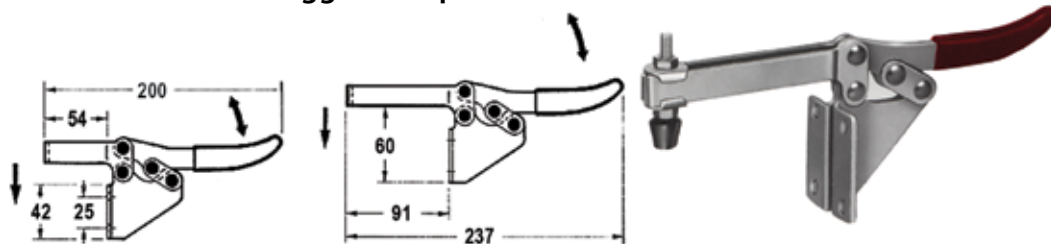

Model	Description	Code
202F	U-bar, vertical mount, straight handle	412180
202FL	Long U-bar, vertical mount, straight handle	412181

Horizontal Handle Toggle Clamps

- Low Profile
- Holding capacity: 90 kg (200 lbs) maximum
- Weight: 130 g (4.6 oz.)
- Handle moves 60°, bar 85°
- Neoprene tipped
- Solid bar
- Vinyl hand grip

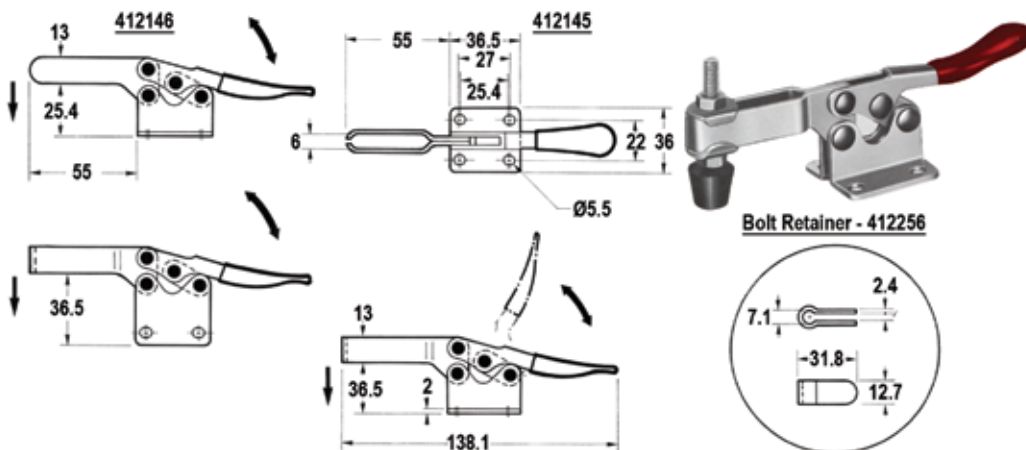

Model	Description	Code
201B	U-bar, flanged base	412145
201BI	U-bar, straight base	412146
201BS	Solid bar, flanged base	412147

Horizontal Handle Toggle Clamps

- Low Profile
- Holding capacity: 340 kg (750 lbs) maximum
- Weight: 640 g (22.6 oz)
- Handle moves 50°, bar 85°
- Neoprene tipped
- Vinyl hand grip

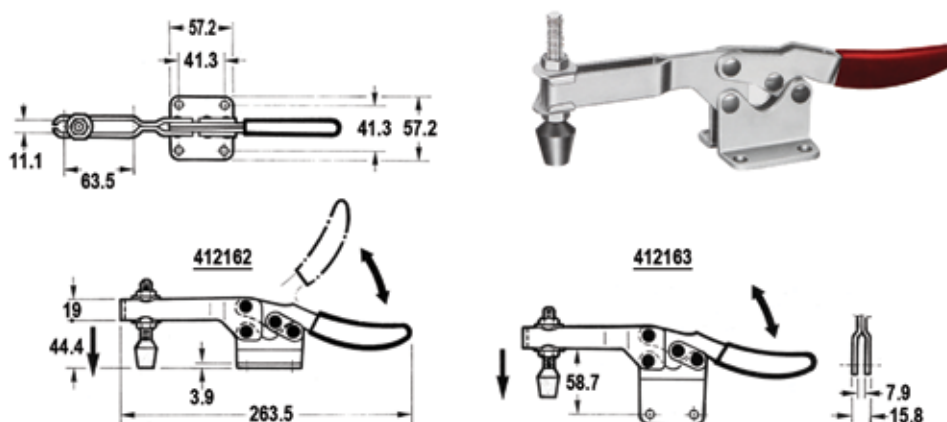

Model	Description	Code
20235	U-bar, flanged base	412162
20236	U-bar, straight base	412163

Toggle Clamps & Accessories

(continued)

Horizontal Handle Toggle Clamps

- Compact size
- Low profile
- Holding capacity: 227 kg (500 lbs) maximum
- Weight: 265 g (9.4 oz)
- Handle moves 65°, bar 90°
- Neoprene tipped
- Vinyl hand grip

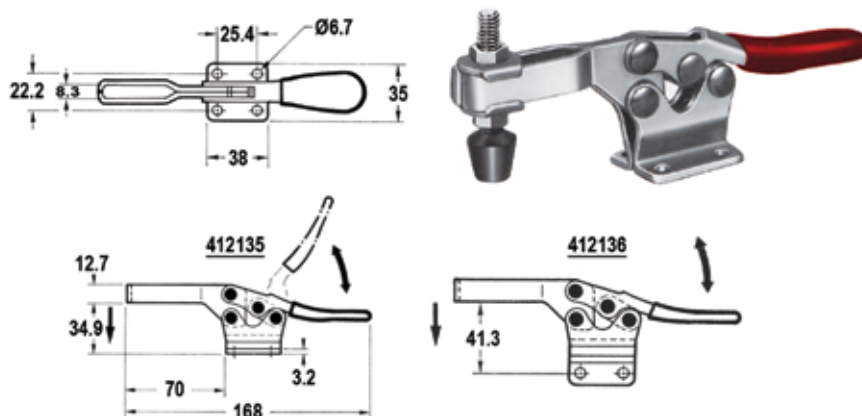

Model	Description	Code
225D	U-bar, flanged base	412135
225DI	U-bar, straight base	412136

Horizontal Handle Toggle Clamps

- Miniature size
- Low profile
- Holding capacity: 27 kg (60 lbs) maximum
- Weight: 43 g (1-1/2 oz)
- Handle moves 80°, bar 90°
- Nylon spindle
- Vinyl hand grip

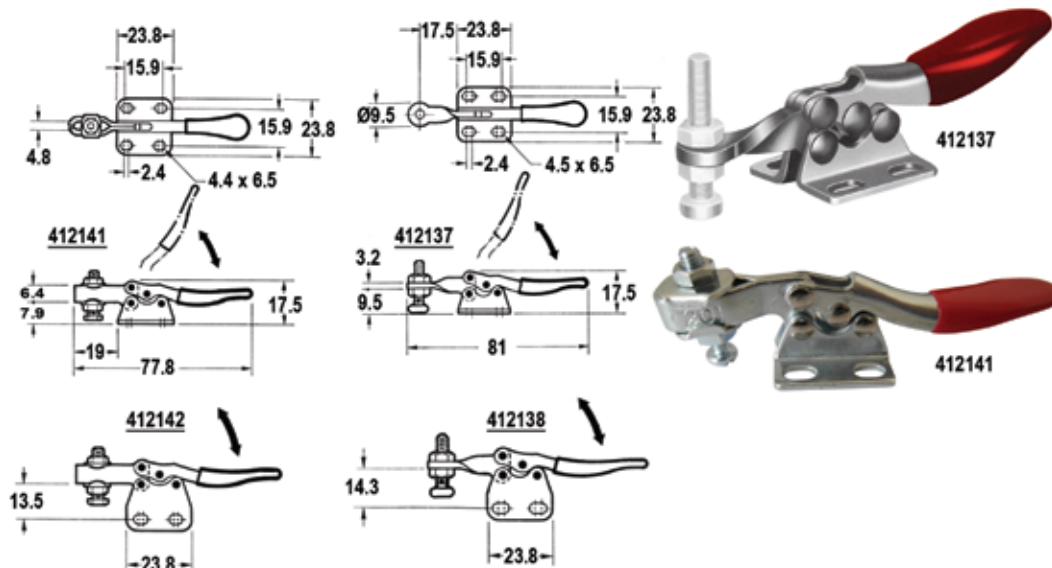

Model	Description	Code
201A	Solid bar, flanged base	412137
201A-1	Solid bar, straight base	412138
201AL	Solid bar, left hand flanged base	412139
201AR	Solid bar, right hand flanged base	412140
201	U-bar, flanged base	412141
201-1	U-bar, straight base	412142

Toggle Clamps & Accessories

(continued)

Horizontal Handle Toggle Clamps – Latch Style

- Holding capacity: Model 40323 – 163.6 kg (360 lbs) maximum; Model 431 – 318 kg (700 lbs) maximum; Model 40341 – 900 kg (2000 lbs) maximum
- Weight: Model 40323 – 70.9 g (2.5 oz); Model 431 – 225 g (8 oz); Model 40341 – 680 g (1 lb, 8 oz)
- Latch plate
- Vinyl hand grip

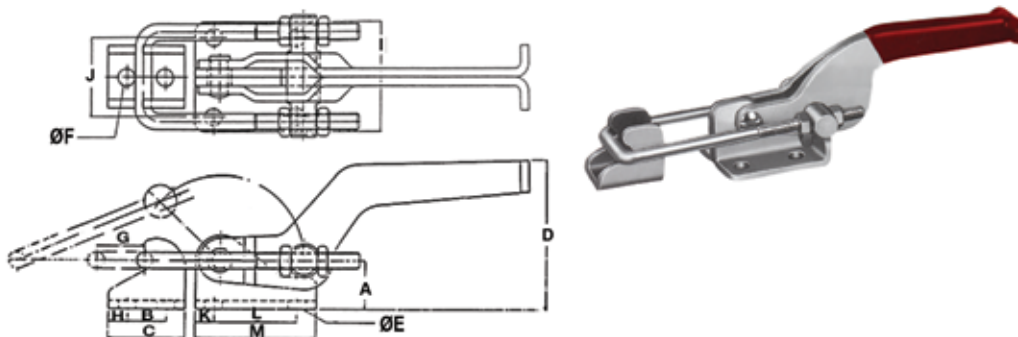

Model	A Inch (mm)	B Inch (mm)	C Inch (mm)	D Inch (mm)	E Inch (mm)	F Inch (mm)	G Inch (mm)	H Inch (mm)	I Inch (mm)	J Inch (mm)	K Inch (mm)	L Inch (mm)	M Inch (mm)	Code
40323	15/32 (12)	25/64 (9.9)	25/32 (19.8)	1-5/32 (29.3)	11/64 (4.4)	11/64 (4.4)	25/64 (9.9)	15/64 (6)	1-7/64 (28.2)	3/4 (19)	13/64 (5.2)	5/8 (15.9)	1-1/32 (26.2)	412157
431	21/32 (16.7)	29/64 (11.5)	1 (25.4)	1-5/8 (41.3)	17/64 (6.7)	1/4 (6.3)	3/8 (9.6)	17/64 (6.8)	1-3/4 (44.5)	1-1/4 (31.8)	1/4 (6.4)	3/4 (19)	1-9/16 (39.7)	412158
40341	59/64 (23.4)	3/4 (19.1)	1-1/2 (38.1)	2-29/32 (74)	11/32 (8.6)	21/64 (8.5)	15/16 (23.8)	3/8 (9.5)	2-1/8 (54)	1-1/2 (38.1)	3/8 (9.5)	1-5/8 (41.3)	2-3/8 (60.3)	412159

Vertical Handle Toggle Clamps – Latch Style

- Holding capacity: Model 40334 – 205 kg (450 lbs) maximum; Model 40344 – 409 kg (900 lbs) maximum
- Weight: Model 40334 – 250 g (9 oz); Model 40344 – 900 g (2 lbs)
- Latch plate
- Vinyl hand grip

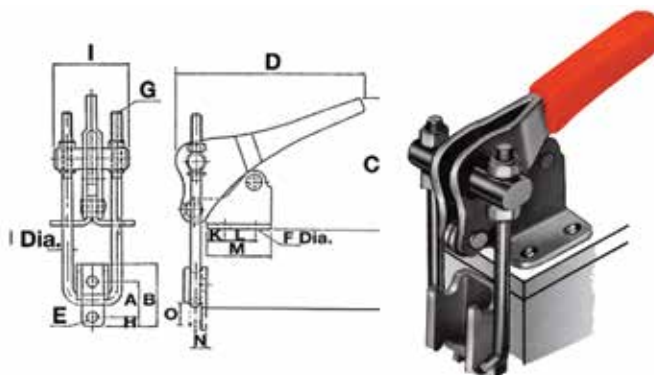

Model	A (mm)	B (mm)	C (mm)	D (mm)	E (mm)	F (mm)	G (mm)	H (mm)	I (mm)	J (mm)	K (mm)	L (mm)	M (mm)	N (mm)	O (mm)	P (mm)	Code
40334	20.6	38.1	61.9	120	5.6	7.1	M6 x 1	7.1	41.3	6.35	7.1	19.1	33.3	8.7	17.5	102	412186
40344	27	54	84.1	130.2	8.7	8.7	M8 x 1.25	9.5	60.3	7.9	7.9	31.8	47.6	12.7	28.6	150	412187

Toggle Clamps & Accessories

(continued)

Latch Toggle Clamps – Hook Style

- Holding capacity: Model 451 – 170 kg (374 lbs) maximum; Model 40371 – 340 kg (750 lbs) maximum
- Weight: Model 451 – 270 g (10 oz); Model 40371 – 624 g (1 lb, 6 oz)
- Vinyl hand grip

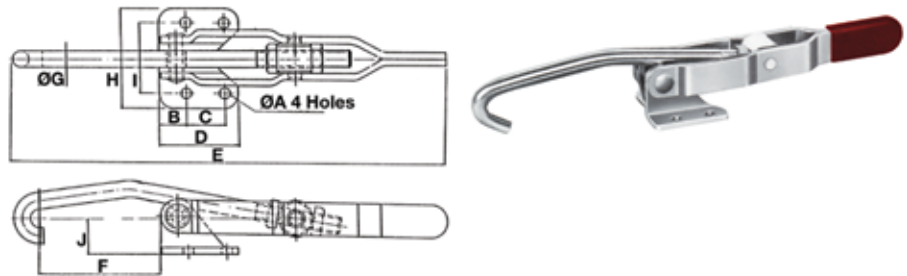

Model	A Inch (mm)	B Inch (mm)	C Inch (mm)	D Inch (mm)	E Inch (mm)	F Inch (mm)	G Inch (mm)	H Inch (mm)	I Inch (mm)	J Inch (mm)	Code
451	7/32 (5.6)	1/2 (12.7)	3/4 (19)	1-1/2 (38.1)	8-5/16 (211.1)	2-5/16 (58.7)	5/16 (8)	1-15/16 (49.2)	1-3/8 (34.9)	3/4 (19)	412160
40371	11/32 (8.7)	5/16 (7.9)	1-1/4 (31.8)	1-7/8 (47.6)	11-1/4 (285.8)	3-1/8 (79.4)	3/8 (9.5)	2-19/32 (65.7)	1-15/16 (49.2)	1-25/64 (35.32)	412161

Push/Pull Toggle Clamps

- Holding capacity: Model 36202 – 91 kg; Model 36204 – 136 kg; Model 36206 – 318 kg
- Weight: Model 36202 – 113 g; Model 36204 – 270 g; Model 36206 – 690 g
- Plunger clamp with threaded collar for mounting through panels or plates
- Plunger locks in extended or retracted position
- Vinyl hand grip and jam nut

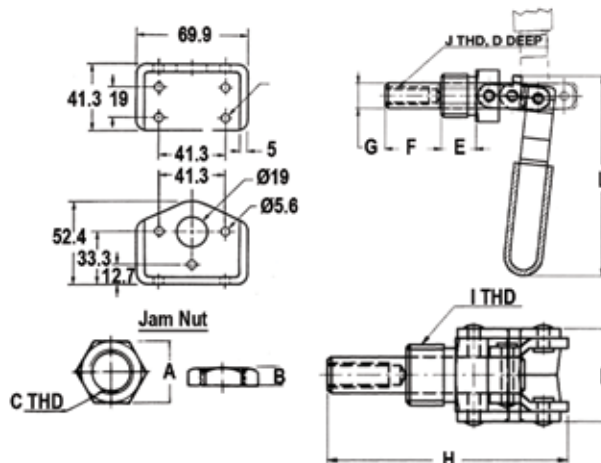

Bracket

Bracket not included

Code

412170

Toggle Clamps & Accessories

(continued)

Push/Pull Toggle Clamps

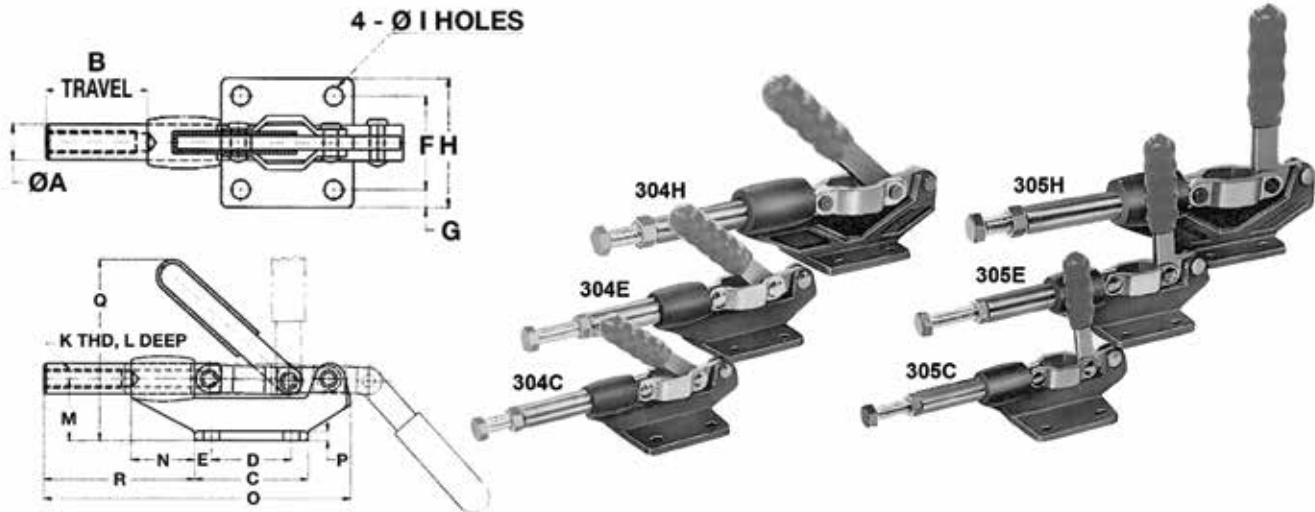

- Available for light, medium, or heavy duty operations
- Supplied with a ductile iron base which is precision machined for flatness
- Close tolerances between the base and plunger allow clamps to be used for pin location gages as well as clamping devices
- Plunger locks in extended or retracted position
- Light and medium duty clamps are supplied with heavy duty rivets
- Heavy duty clamps are supplied with bushings and removable hardened ground pins
- Vinyl hand grip (spindles not included)

Model	A mm Inch	B mm Inch	C mm Inch	D mm Inch	E mm Inch	F mm Inch	G mm Inch	H mm Inch	I mm Inch	J mm Inch	K Thread	L mm Inch	M mm Inch	N mm Inch	O mm Inch	P mm Inch	Q mm Inch	R mm Inch
304C	12.7 1/2	30.2 1-3/16	52.4 2-1/16	35 1-3/8	8.7 11/32	41.4 1-5/8	8 5/16	57.2 2-1/4	6.7 17/64	6.4 1/4	5/16 - 18	30.2 1-3/16	25.4 1	20.6 13/16	125.4 4-15/16	4.8 3/16	74.6 2-15/16	52.4 2-1/16
305C	12.7 1/2	30.2 1-3/16	52.4 2-1/16	35 1-3/8	8.7 11/32	41.4 1-5/8	8 5/16	57.2 2-1/4	6.7 17/64	6.4 1/4	5/16 - 18	30.2 1-3/16	25.4 1	20.6 13/16	125.4 4-15/16	4.8 3/16	90.5 3-9/16	52.4 2-1/16
304E	16 5/8	41.4 1-5/8	58.8 2-5/16	41.4 1-5/8	8.7 11/32	41.4 1-5/8	8 5/16	57.2 2-1/4	8.3 21/64	8 5/16	3/8 - 16	39.7 1-9/16	31.8 1-1/4	31.8 1-1/4	158.8 6-1/4	4.8 3/16	98.4 3-7/8	81 3-3/16
305E	16 5/8	41.4 1-5/8	58.8 2-5/16	41.4 1-5/8	8.7 11/32	41.4 1-5/8	8 5/16	57.2 2-1/4	8.3 21/64	8 5/16	3/8 - 16	39.7 1-9/16	31.8 1-1/4	31.8 1-1/4	158.8 6-1/4	4.8 3/16	122.2 4-13/16	81 3-3/16
304H	19 3/4	60.4 2-3/8	73.2 2-7/8	50.8 2	11.1 7/16	50.8 2	10.3 13/32	71.4 2-11/16	8.3 21/64	8 5/16	1/2 - 13	49.2 1-15/16	50.8 2	50.8 2	238.2 9-3/8	6.4 1/4	133.4 5-1/4	120.8 4-3/4
305H	19 3/4	60.4 2-3/8	73.2 2-7/8	50.8 2	11.1 7/16	50.8 2	10.3 13/32	71.4 2-11/16	8.3 21/64	8 5/16	1/2 - 13	49.2 1-15/16	50.8 2	50.8 2	238.2 9-3/8	6.4 1/4	171.6 6-3/4	120.5 4-3/4

Model	Holding Capacity kg (lbs)	Weight g (oz)	Handle Angle	Code
304C	227 (500)	340 (12)	45°	412151
305C	227 (500)	340 (12)	90°	412152
304E	386 (850)	580 (20.5)	45°	412153
305E	386 (850)	580 (20.5)	90°	412154
304H	680 (1500)	1480 (52.2)	45°	412155
305H	680 (1500)	1480 (52.2)	90°	412156

Toggle Clamps & Accessories

(continued)

Push/Pull Toggle Clamp

- Heavy duty
- Low profile
- Plunger locks in extended or retracted position
- Forged alloy steel base
- Accepts all 3/8" - 16 spindle (spindle not included)
- Vinyl hand grip

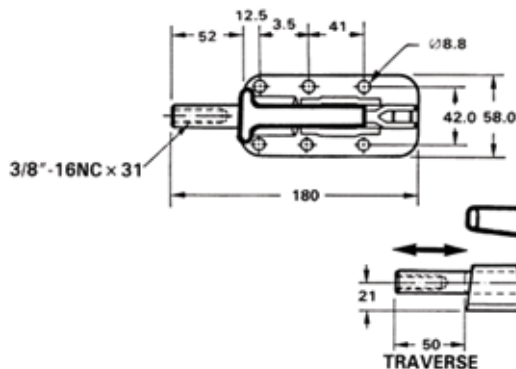

Model	Holding Capacity Maximum kgs (lbs)	Weight g (oz)	Plunger Travel mm (Inch)	Code
36330	1136 (2500)	935 (33)	50.8 (2)	412149

Push/Pull Toggle Clamp – Flanged

- Heavy duty
- Plunger locks in extended or retracted position
- Accepts 1/2" - 13 spindles (spindle not included)
- Vinyl hand grip

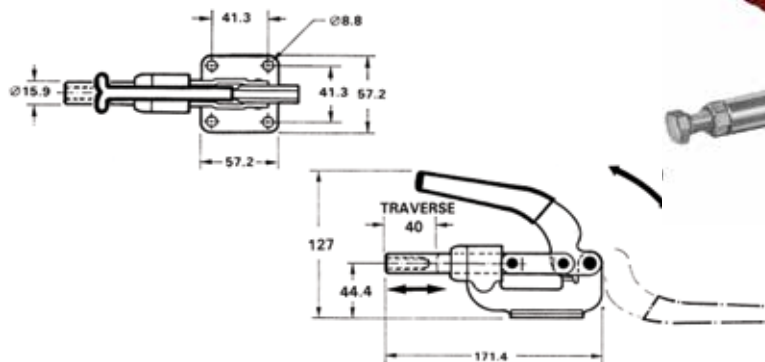

Holding Capacity Maximum kgs (lbs)	Weight g (oz)	Plunger Travel mm (Inch)	Code
364 (800)	800 (28.2)	41.4 (1-5/8)	412150

Toggle Clamps & Accessories

(continued)

Toggle Pliers

- Improved handle design for operator comfort
- Hex head spindle assembly

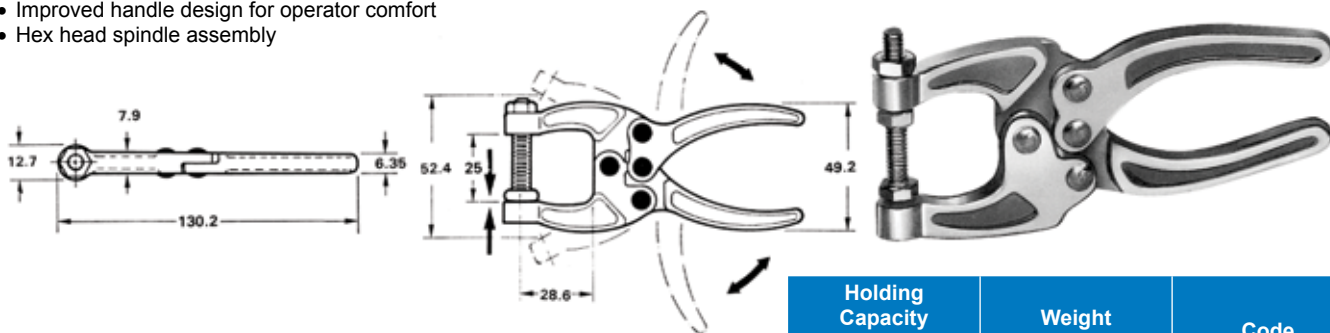

Holding Capacity Maximum kgs (lbs)	Weight g (oz)	Code
90 (200)	185 (6.5)	412165

Toggle Pliers

- Improved handle design for operator comfort
- Hex head spindle assembly

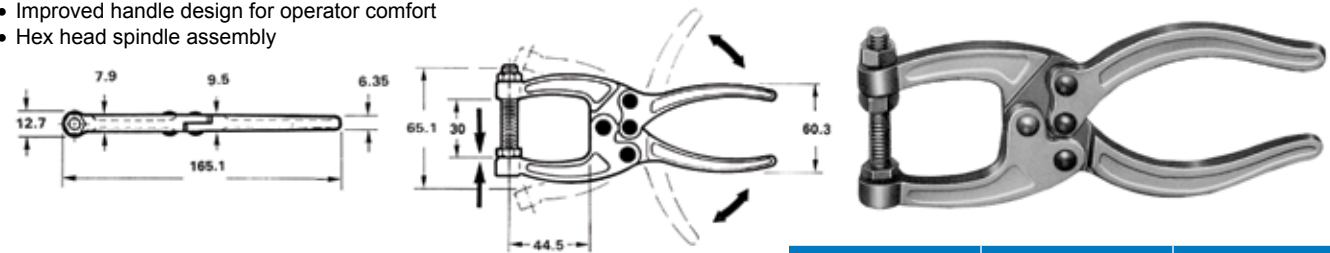

Holding Capacity Maximum kgs (lbs)	Weight g (oz)	Code
159 (350)	290 (10.2)	412166

Adjustable Spindle Assembly

Flat Cushion Top Bonded Neoprene Cap



Adjustable Spindle Assembly

Standard Adjustable



Model	Description	Code
FC-10138	10-24 x 1-3/8	412200
FC-14134	1/4-20 x 1-3/4	412201
FC-14218	1/4-20 x 2-1/8	412202
FC-56212	5/16-18 x 2-1/2	412203
FC-56300	5/16-18 x 3	412204
FC-38312	3/8-16 x 3-1/2	412205
FC-38412	3/8-16 x 4-1/2	412206

Model	Description	Code
SA-08034	8-32 x 3/4 (Nylon)	412210
SA-10118	10-24 x 1-1/8	412211
SA-14112	1/4-20 x 1-1/2	412212
SA-14134	1/4-20 x 1-3/4	412213
SA-56200	5/16-18 x 2	412214
SA-56212	5/16-18 x 2-1/2	412215
SA-38300	3/8-16 x 3	412216
SA-38400	3/8-16 x 4	412217
SA-12300	1/2-13 x 3	412218
SA-12412	1/2-13 x 4-1/2	412219
SA-58500	5/8-11 x 5	412220

Toggle Clamps & Accessories

(continued)

Adjustable Spindle Assembly Pointed Tip Bonded Neoprene Cap



Adjustable Spindle Assembly Model SF



Model	Description	Code	Model	Description	Code
CC-10138	10-24 x 1-3/8	412221	SF-14214	1/4-20 x 2-1/4	412230
CC-14134	1/4-20 x 1-3/4	412222	SF-56234	5/16-18 x 2-3/4	412231
CC-14218	1/4-20 x 2-1/8	412223	SF-38300	3/8-16 x 3	412232
CC-56212	5/16-18 x 2-1/2	412224	SF-12400	1/2-13 x 4	412233
CC-38312	3/8-16 x 3-1/2	412225			

Toggle Clamp Reference Chart

Major Brand Crossover

Description	KAR Code	Kakuta	Destaco	Carr Lane	Jergens
101A Toggle Clamp	412101	HV150	201-U	CL-150-VTC	70310
12050 Toggle Clamp	412102	HV250	202	CL-250-VTC	70330
12055 Toggle Clamp	412103	HV251-B	202-B	CL-251-VTC	70335
12060 Toggle Clamp	412104	-	-	-	-
12065 Toggle Clamp	412105	-	-	-	-
12070 Toggle Clamp	412106	HV252-T	202-T	CL-252-VTC	70340
12075 Toggle Clamp	412107	HV251-BT	202-TB	-	71016
12080 Toggle Clamp	412108	-	-	-	-
SH-12050-U Toggle Clamp	412110	HV250-U	202-U	-	70342
SH-12265 Toggle Clamp	412111	HV650	210-U	CL-650-VTC	70440
12270 Toggle Clamp	412112	HV651-B	210-UB	CL-651-VTC	70445
12275 Toggle Clamp	412113	HV550	210-S	CL-550-VTC	70420
12280 Toggle Clamp	412114	HV551-B	210-SB	CL-551-VTC	70425
10247 Toggle Clamp	412115	HV850	247-U	CL-850-VTC	70470
10249 Toggle Clamp	412117	HV750	247-S	CL-750-VTC	70460
10250 Toggle Clamp	412118	HV751-B	247-SB	CL-751-VTC	71030
12130 Toggle Clamp	412119	HV450	207-U	CL-450-VTC	70380
12131 Toggle Clamp	412120	HV452-T	207-TU	CL-452-VTC	70390
12132 Toggle Clamp	412121	HV453-L	207-UL	CL-453-VTC	70395
12137 Toggle Clamp	412125	HV451-BL	207-ULB	-	71025
12138 Toggle Clamp	412126	HV451-BTL	207-TULB	-	71026
12140 Toggle Clamp	412127	HV350	207-S	CL-350-VTC	70350
12142 Toggle Clamp	412129	HV353-L	207-L	CL-353-VTC	70365
12143 Toggle Clamp	412130	HV352-TL	207-TL	-	71023
12145 Toggle Clamp	412131	HV351-B	207-SB	CL-351-VTC	70355
225D Toggle Clamp	412135	HH450	225-U	CL-450-HTC	70250
GH-225-DI Toggle Clamp	412136	HH451-B	225-UB	CL-451-HTC	70255
GH201-A Toggle Clamp	412137	HH150	205-S	CL-150-HTC	70210
201AI Toggle Clamp	412138	HH151-B	205-SB	CL-151-HTC	70215
201AL Toggle Clamp	412139	HH154-LE	205-SL	CL-153-HTC	70211
201AR Toggle Clamp	412140	HH155-R	205-SR	CL-152-HTC	71001
201 Toggle Clamp	412141	HH250	205-U	CL-250-HTC	70230
201-I Toggle Clamp	412142	HH250-B	205-UB	CL-251-HTC	70235
201-R Toggle Clamp	412144	HH255-R	205-UR	CL-252-HTC	71003
GH-201 B Toggle Clamp	412145	HH350	215-U	CL-350-HTC	70240
201BI Toggle Clamp	412146	HH351-B	215-UB	CL-351-HTC	70245

Toggle Clamp Reference Chart

Major Brand Crossover (continued)

Description	KAR Code	Kakuta	Destaco	Carr Lane	Jergens
GH-201-BS Toggle Clamp	412147	HH350-S	215-S	CL-300-HTC	71008
201-BSI Toggle Clamp	412148	HH351-SB	215-SB	-	71009
36330 Push/Pull Clamp	412149	SL350	630	CL-350-SPC	70860
36010 Push/Pull Clamp	412150	SL250	610	CL-250-SPC	70840
304C Push/Pull Clamp	412151	SL100	603	CP-100-PC	70810
305C Push/Pull Clamp	412152	-	-	-	-
304E Push/Pull Clamp	412153	SL200	608	CL-200-PC	70830
305E Push/Pull Clamp	412154	-	-	-	-
304H Push/Pull Clamp	412155	SL300	-	CL-300-PC	70850
305H Push/Pull Clamp	412156	-	-	-	-
GH-40323 Latch Clamp	412157	FA100	323	CL-100-PA	70558
GH-431 Latch Clamp	412158	FA200	331	CL-200-PA	70560
GH-40341 Latch Clamp	412159	FA300	341	CL-300-PA	70562
451 Latch Clamp	412160	PA250	351	CL-250-PA	70570
GH-40371 Latch Clamp	412161	PA270	371	-	-
GH-20235 U-Bar Flanged Base	412162	HH550	235-U	CL-550-HTC	-
20236 Toggle Clamp	412163	HH551-BN	235-UB	-	-
50350 Toggle Clamp	412165	SA150	424	CL-50-PL	70710
50360 Toggle Clamp	412166	SA250	441	CL-150-PL	70720
36202 Toggle Clamp	412167	FM50	602	CL-150-TPC	70118
36204 Toggle Clamp	412168	FM150	604	CL-250-TPC	70120
36206 Toggle Clamp	412169	FM250	624	CL-350-TPC	70140
101B Toggle Clamp	412175	-	-	-	-
202F Toggle Clamp	412180	-	-	-	-
202FL Toggle Clamp	412181	-	-	-	-
40334 Toggle Clamp	412186	FA230	334	CL-210-PA	71042
40344 Toggle Clamp	412187	FA330	344	CL-310-PA	70565

F-Clamps

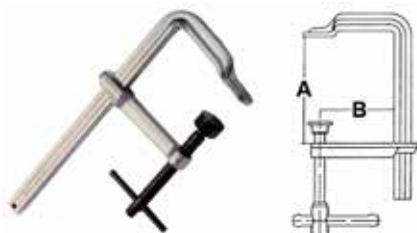

- Material: ANSI 1045 medium carbon steel, chrome plated
- Hardness: HRC 36°±2
- T-handle
- P-type pad

Medium Duty 2400

Heavy Duty 4600

Extra Heavy Duty

A Span (Inch)	B Span (Inch)	Rail Thickness (Inch)	Weight (lbs)	Code
10	4.75	1.06 x 0.51	4.6	412330
12	4.75	1.06 x 0.51	4.9	412331
16	4.75	1.06 x 0.51	5.4	412332
20	4.75	1.06 x 0.51	6.0	412333
24	4.75	1.06 x 0.51	6.1	412334

A Span (Inch)	B Span (Inch)	Rail Thickness (Inch)	Weight (lbs)	Code
12	5.50	1.18 x 0.59	6.7	412340
16	4.75	1.18 x 0.59	7.1	412341
20	5.50	1.18 x 0.59	8.1	412342
24	4.75	1.18 x 0.59	9.1	412343

A Span (Inch)	B Span (Inch)	Rail Thickness (Inch)	Weight (lbs)	Code
12	7.00	1.57 x 0.79	12	412350

Clamping Pads

Three types of replacement clamping pads:

- P: For general purpose
- R: For cold work purpose
- V: For clamping round pipes or round bars



Type	Medium Duty	Heavy Duty
	Code	Code
P	412360	412364
R	412361	412365
V	412362	412366

C-Clamps

Standard & Heavy Duty



- Steel forged



- Steel forged
- Heat-treated

Capacity (Inch)	Throat Depth (Inch)	Minimum Proof Test (lbs)	Weight (lbs)	Standard Duty	Heavy Duty
				Code	Code
0-1	0.945	2860	0.5	416161	–
0-2	1.220	4400	0.9	416162	416172
0-3	1.575	6160	1.8	416163	416173
0-4	2.008	6600	2.8	416164	416174
0-5	2.441	7260	4.2	416165	–
0-6	2.756	7920	7.1	416166	416176
0-8	3.701	13200	10.0	416167	416177
0-10	4.724	15400	13.8	416168	416178
0-12	4.921	17600	20.7	416169	416179